

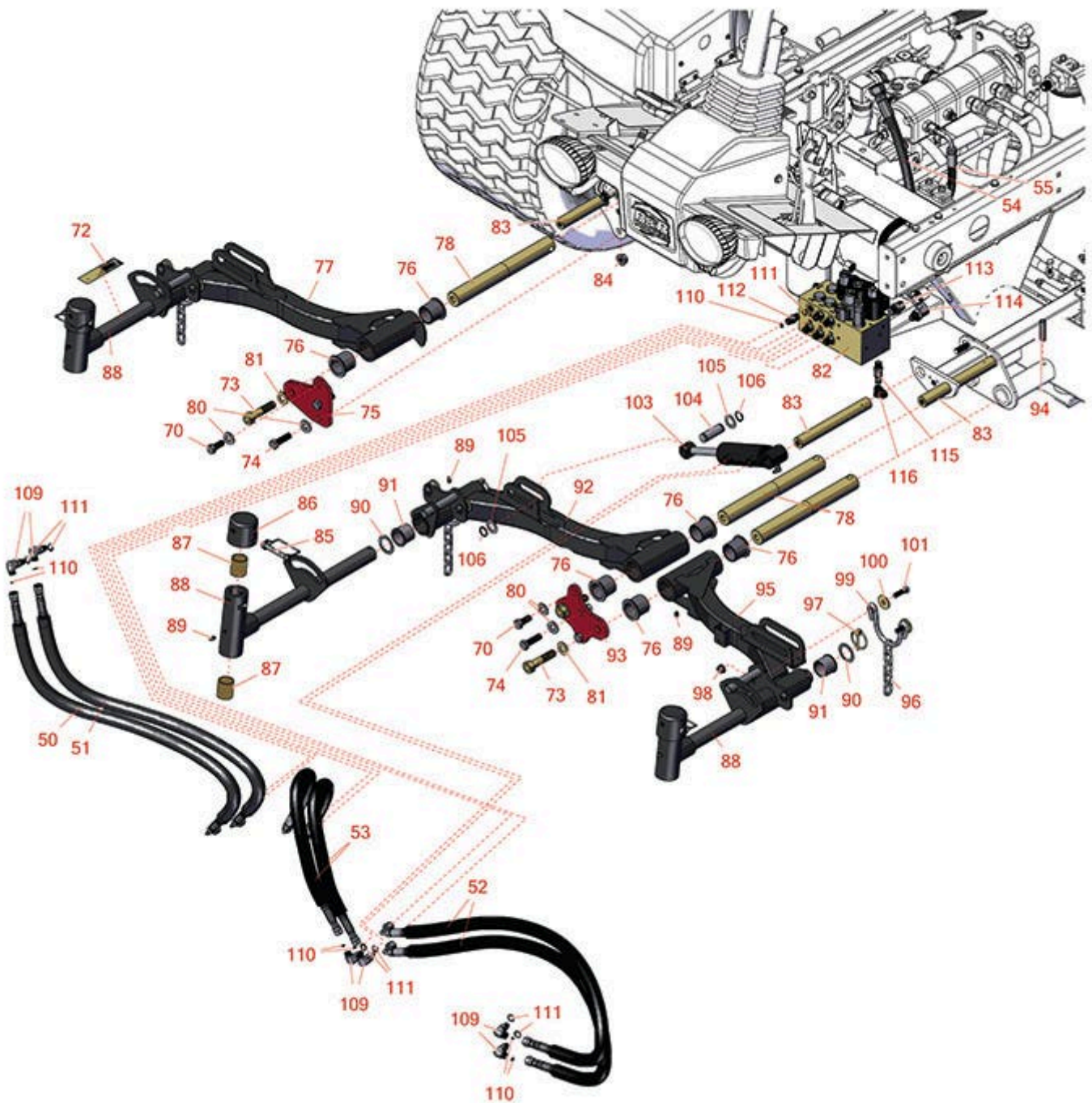

# Replaces Toro Reelmaster 5510-G Parts

Traction Unit  
Front Lift Arm



All original equipment manufacturers names and part numbers are used for identification purposes only, and we are in no way implying that our products are original equipment parts. Prices subject to change without notice.



# Replaces Toro Reelmaster 5510-G Parts

Traction Unit  
Front Lift Arm



Item No	R&R Part No.	OEM Part No.	Description	Qty Req	Price Each	Order Quantity
<b>Hoses</b>						
50	<b>R106-3693</b>	106-3693	Hydraulic Hose Assy	1	<b>66.55</b>	
51	<b>R106-3692</b>	106-3692	Hydraulic Hose Assy	1	<b>53.95</b>	
52	<b>R85-4940</b>	85-4940	Hydraulic Hose Assy	2	<b>61.95</b>	
53	<b>R93-6887</b>	93-6887	Hydraulic Hose Assy	2	<b>36.50</b>	
54	<b>R117-0180</b>	117-0180	Hydraulic Hose Assy	1	<b>58.95</b>	
55	<b>R92-5694</b>	92-5694	Hydraulic Hose Assy	1	<b>59.35</b>	
<b>Other Parts Available</b>						
70	<b>R325-5</b>	01-150-0250, 01-178-0810, 19-8000, 20-86-AGD, 3226-1, 325-5, 513375	Bolt - Hex HD 1/2-13 x 1-1/4	2	<b>0.83</b>	
72	<b>R110-9642</b>	110-9642	Decal	3	<b>8.70</b>	
73	<b>R327-7</b>	01-150-0700, 01-150-0710, 01-178-1020, 20-125-AGD, 20-126-AGD, 327-7	Bolt - Hx HD	2	<b>10.95</b>	
74	<b>R325-7</b>	01-150-0380, 01-178-0814, 3226-3, 325-7, 48-9490	Bolt - 1/2-13 x 1 3/4 Hex HD Gr 5	4	<b>0.84</b>	
75	<b>R117-5153-01</b>	117-5153-01	Plate-Bridge 5	1	<b>24.45</b>	
76	<b>R69-6470</b>	69-6470	Bushing - Flanged	6	<b>6.15</b>	
77	<b>R110-0995</b>	110-0995	Lift Arm - No. 5	1	<b>318.30</b>	

All original equipment manufacturers names and part numbers are used for identification purposes only, and we are in no way implying that our products are original equipment parts. Prices subject to change without notice.



# Replaces Toro Reelmaster 5510-G Parts

*Traction Unit  
Front Lift Arm*



Item No	R&R Part No.	OEM Part No.	Description	Qty Req	Price Each	Order Quantity
78	<b>R117-0208</b>	117-0208	Shaft- Pivot - Lift Arm	3	<b>75.85</b>	
80	<b>R87-7270-01</b>	87-7270, 87-7270-01	Washer - Flat 1/2	4	<b>0.29</b>	
81	<b>R99-7667</b>	99-7667	Washer - Flat 5/8	2	<b>6.05</b>	
82	<b>R105-7577</b>	105-7577	Manifold Assy - Lift Blocks	1	<b>1845.95</b>	
83	<b>R117-0148</b>	117-0148	Pin - Hyd Cyl	3	<b>29.30</b>	
84	<b>R32128-23</b>	32128-23, 3218-23, 99-5107	Nut - Lock Hex Flanged 1/2-13	4	<b>1.45</b>	
85	<b>R107-7400</b>	107-7400	Pin - Lynch	3	<b>6.95</b>	
86	<b>R107-4027</b>	107-4027	Cap - Pivot Yoke	3	<b>14.25</b>	
87	<b>R256-254</b>	256-254	Bushing 1-1/8 x 1.375 x 1.5	6	<b>5.15</b>	
88	<b>R107-2052</b>	107-2052, 138-1248	Pivot Yoke Assy	3	<b>250.95</b>	
89	<b>R302-5</b>	21-6010, 302-11, 302-37, 302-47, 302-5, 302-57, 302-58, 302-6, 31-0300, 32-9660, 60-0800, 62-3880, 92-4181	Fitting - Grease	9	<b>0.27</b>	
90	<b>R76-2980</b>	76-2980	Washer - Thrust	6	<b>4.55</b>	
91	<b>R104-0015</b>	104-0015, 104-8339	Bushing - Flanged	6	<b>5.15</b>	
92	<b>R110-0991</b>	110-0991	Lift Arm - No. 1	1	<b>311.50</b>	

All original equipment manufacturers names and part numbers are used for identification purposes only, and we are in no way implying that our products are original equipment parts. Prices subject to change without notice.



# Replaces Toro Reelmaster 5510-G Parts

*Traction Unit  
Front Lift Arm*



Item No	R&R Part No.	OEM Part No.	Description	Qty Req	Price Each	Order Quantity
93	<b>R117-5154-01</b>	117-5154-01	Plate-Bridge 1 and 4	1	<b>25.10</b>	
94	<b>R32121-122</b>	01-153-0140, 32121-122	Pin - Roll 1/2 x 2	3	<b>1.50</b>	
95	<b>R114-8874</b>	114-8874	Lift Arm - No. 4	1	<b>294.05</b>	
96	<b>R84-2451</b>	84-2451	Chain - Straight 5	3	<b>4.75</b>	
97	<b>R92-1298</b>	92-1298	Pin - Klik	3	<b>2.45</b>	
98	<b>R104-8301</b>	104-8301, 104-9301, 109-6658, 133-7570	Locknut - 3/8-16 Nylon Flanged	28	<b>0.84</b>	
99	<b>R110-0922</b>	110-0922	Hoop - Chain	3	<b>8.35</b>	
100	<b>R63-8410</b>	53-6380, 63-4810, 63-8410	Washer - Isolator Bushing	6	<b>0.77</b>	
101	<b>R400264</b>	01-150-0180, 01-178-0610, 20-48-AD, 20-48-AGD, 32-9160, 3224-3, 323-29, 323-7, 400264, 908035P	Bolt - Hex HD 3/8-16 x 1-1/4	6	<b>0.40</b>	
103	<b>R119-6988</b>	119-6988	Hydraulic Cylinder	1	<b>349.60</b>	
104	<b>R104-0046</b>	104-0046	Pin - Slide - Cylinder	3	<b>7.15</b>	
105	<b>R3-6498</b>	3--6498, 3-6498, 47-8270	Washer - Thrust	6	<b>4.10</b>	
106	<b>R32120-93</b>	32120-93	Snap Ring - HD	6	<b>1.20</b>	
109	<b>R340-132</b>	340-132	Hydraulic Fitting - 90 Deg	6	<b>14.40</b>	

All original equipment manufacturers names and part numbers are used for identification purposes only, and we are in no way implying that our products are original equipment parts. Prices subject to change without notice.



# Replaces Toro Reelmaster 5510-G Parts

*Traction Unit  
Front Lift Arm*



Item No	R&R Part No.	OEM Part No.	Description	Qty Req	Price Each	Order Quantity
110	<b>R237-21</b>	237-21, 327-21	O-Ring	12	<b>0.47</b>	
111	<b>R237-22</b>	107-8844, 237-22, 237-78	O-Ring	12	<b>0.62</b>	
112	<b>R340-92</b>	340-92	Hydraulic Fitting - Striaight	6	<b>6.95</b>	
113	<b>R340-4</b>	340-4	Hydraulic Fitting - Male Connector	1	<b>7.95</b>	
114	<b>R340-18</b>	340-18	Hydraulic Fitting	1	<b>20.95</b>	
115	<b>R59-7410</b>	59-7410	Tip-Nipple	1	<b>20.15</b>	
116	<b>R354-79</b>	354-79	Cap-Dust	1	<b>4.85</b>	

All original equipment manufacturers names and part numbers are used for identification purposes only, and we are in no way implying that our products are original equipment parts. Prices subject to change without notice.