

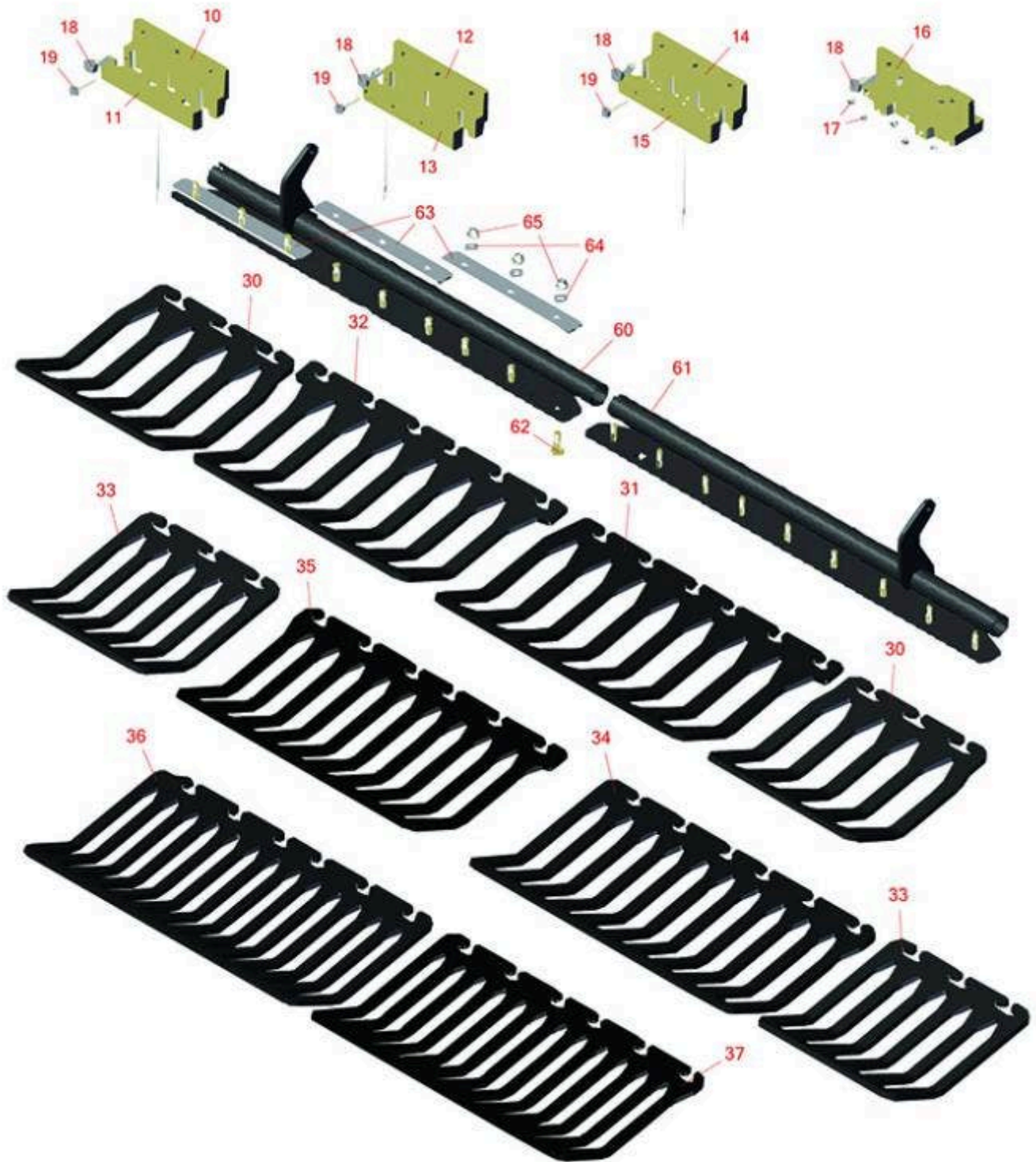

# Replaces Toro ProCore 864 Parts

Aerating Unit  
Tine Holders



All original equipment manufacturers names and part numbers are used for identification purposes only, and we are in no way implying that our products are original equipment parts. Prices subject to change without notice.



# Replaces Toro ProCore 864 Parts

Aerating Unit  
Tine Holders



Item No	R&R Part No.	OEM Part No.	Description	Qty Req	Price Each	Order Quantity
---------	--------------	--------------	-------------	---------	------------	----------------

## Tine Holders

10	<b>R108-2122-03</b>	108-2122-03, 110-4692-03	Tine HOLDER,3 Tine 7/8 Mt.	6	<b>60.98</b>	
11	<b>R108-2124-03</b>	108-2124-03	Clamp - Tine Holder 3 Tine 7/8 Mt.	6	<b>36.15</b>	
12	<b>R105-1036-03</b>	105-1036-03	Tine Holder - 3 Tine 3/4 Mt	6	<b>60.85</b>	
13	<b>R105-1038-03</b>	105-1038-03	Clamp - Tine Holder 3 Tine 3/4 Mt.	6	<b>25.10</b>	
14	<b>R105-1045-03</b>	105-1045-03	Tine Holder, 4 Tine 3/4 Mt.	6	<b>60.85</b>	
15	<b>R105-1032-03</b>	105-1032-03	Clamp - 4 Tine x 3/4 Tine Holder	6	<b>25.10</b>	
16	<b>R105-1184</b>	105-1184	Tine Holder	6	<b>62.45</b>	

*Tech Note: Includes R150691 Set Screws:*

17	<b>R150691</b>	150691	Screw - Set Nyloc 3/8-16 x 3/8	60	<b>1.10</b>	
18	<b>R325-5</b>	01-150-0250, 01-178-0810, 19-8000, 20-86-AGD, 3226-1, 325-5, 513375	Bolt - Hex HD 1/2-13 x 1-1/4	12	<b>0.83</b>	
19	<b>R323-8</b>	01-150-0060, 01-178-0612, 20-49-AD, 20-49-AGD, 323-8, 3273-41, 908036P	Bolt - Hex HD 3/8-16 x 1-1/2 GR8	24	<b>1.50</b>	

## Turf Guards

30	<b>R120-1044</b>	105-1106, 110-4357, 120-1044	Turf Guard - 3 Tine (Short)	2	<b>56.05</b>	
31	<b>R120-1057</b>	120-1057	Turf Guard - 3 Tine (RH)	1	<b>96.95</b>	
32	<b>R120-1058</b>	120-1058	Turf Guard - 3 Tine (LH)	1	<b>96.95</b>	

<p>All original equipment manufacturers names and part numbers are used for identification purposes only, and we are in no way implying that our products are original equipment parts. Prices subject to change without notice.</p>
--



# Replaces Toro ProCore 864 Parts

*Aerating Unit  
Tine Holders*



Item No	R&R Part No.	OEM Part No.	Description	Qty Req	Price Each	Order Quantity
33	<b>R120-1045</b>	105-1104, 110-4361, 120-1045	Turf Guard - 4 Tine (Short)	2	<b>56.80</b>	
34	<b>R120-1059</b>	120-1059	Guard-Turf, 4-TINE (RH)	1	<b>104.95</b>	
35	<b>R120-1060</b>	120-1060	Guard-Turf, 4-TINE (LH)	1	<b>104.95</b>	
36	<b>R120-1061</b>	120-1061	Turf Guard - 5 Tine (RH)	1	<b>61.95</b>	
37	<b>R120-1062</b>	120-1062	Guard-Turf, 5 Tine (LH)	1	<b>61.95</b>	
60	<b>R110-4619</b>	110-4619	Turfguard Assy - LH with Screws	1	<b>238.30</b>	
61	<b>R110-4620</b>	110-4620	Turfguard Assy - RH with Screws	1	<b>238.30</b>	
62	<b>R125-3318</b>	125-3318	Screw - Rib Neck	12	<b>2.60</b>	
63	<b>R110-4274-03</b>	110-4274-03	Clamp - Turf Guard	6	<b>14.78</b>	
64	<b>R453011</b>	01-166-0100, 01-166-0120, 01-166-0270, 01-166-0500, 01-166-0600, 01-166-0620, 132-4593, 2356-3, 237-12, 24-10-AD, 24-11-AD, 24-11-BD, 24-12-AD, 24-12-BD, 30-9310, 32-8190, 3256-24, 3256-3, 3256-36, 3256-4, 453011, 47-9950, 48-9220, 513458, 7-0052	Washer - Flat 3/8 SAE Y/Zinc	12	<b>0.11</b>	

All original equipment manufacturers names and part numbers are used for identification purposes only, and we are in no way implying that our products are original equipment parts. Prices subject to change without notice.



# Replaces Toro ProCore 864 Parts

*Aerating Unit  
Tine Holders*



Item No	R&R Part No.	OEM Part No.	Description	Qty Req	Price Each	Order Quantity
65	<b>R104-8301</b>	104-8301, 104-9301, 109-6658, 133-7570	Locknut - 3/8-16 Nylon Flanged	12	<b>0.84</b>	

All original equipment manufacturers names and part numbers are used for identification purposes only, and we are in no way implying that our products are original equipment parts. Prices subject to change without notice.