

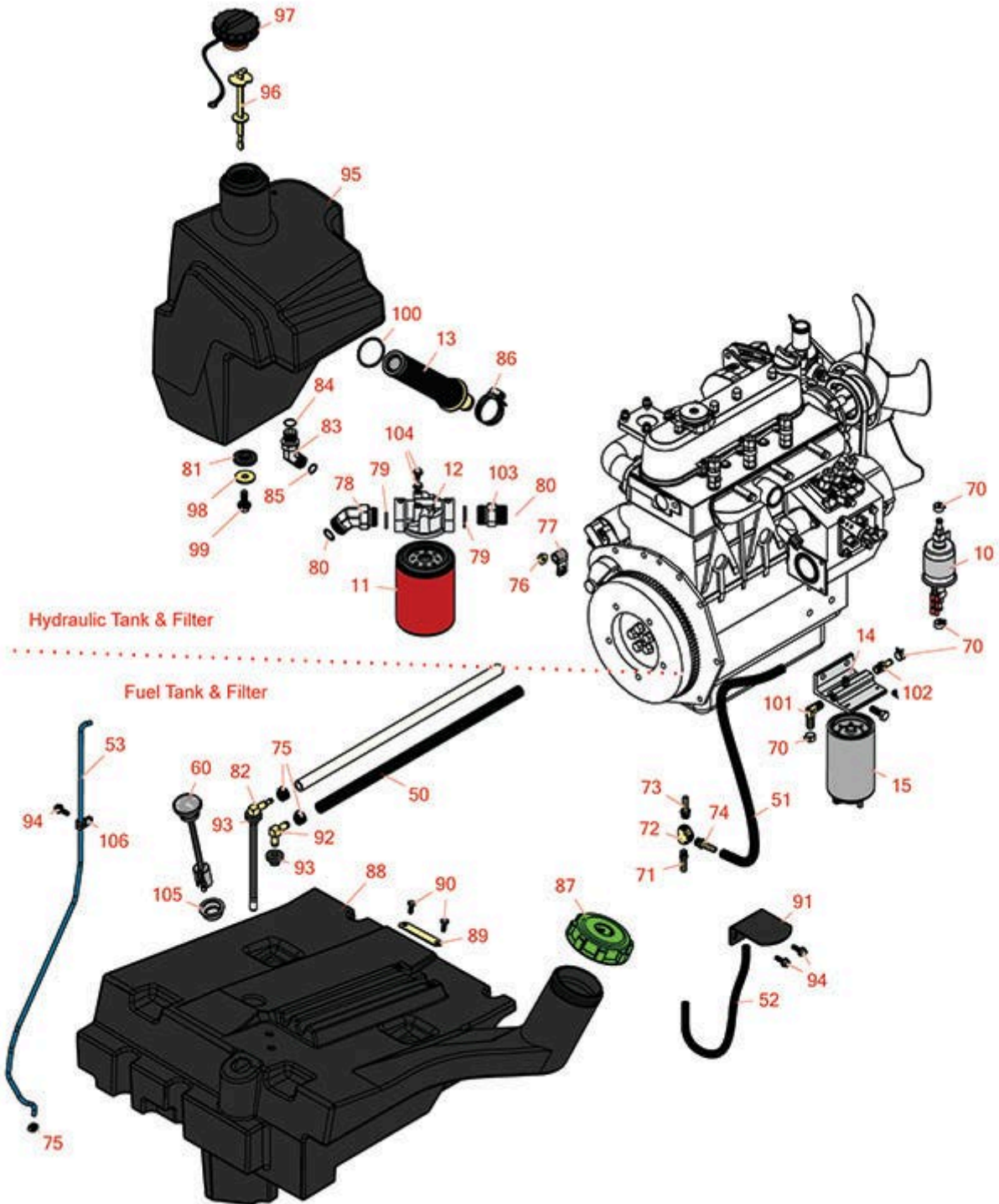

Replaces Toro Reelmaster 3550-D Parts

Traction Unit - Model 03910

Hydraulic & Fuel Tank



All original equipment manufacturers names and part numbers are used for identification purposes only, and we are in no way implying that our products are original equipment parts. Prices subject to change without notice.



Replaces Toro Reelmaster 3550-D Parts

Traction Unit - Model 03910

Hydraulic & Fuel Tank



Item No	R&R Part No.	OEM Part No.	Description	Qty Req	Price Each	Order Quantity
Filters						
10	R110-8806	110-8806	Fuel Pump and Filter Assy	1	165.40	
11	R86-3010	23-9740, 239470, 28-1370, 281370, 353-387, 353387, 54-0110, 540110, 76-6490, 86-3010, 863010, Dec-70	Baldwin Hydraulic Oil Filter	1	10.20	
12	R92-5821	86-3000, 92-5821	Filter - Head	1	66.65	
13	R104-7546	104-7546, 104-7546`	Strainer - Tank	1	101.40	
14	R110-9044	110-9044	Donaldson Water/Fuel Seperator Assy	1	41.50	
15	R110-9049	110-9049	Donaldson Fuel Filter - Spin On	1	17.75	
Hoses						
50	R110-6187	110-6187	Hose-Fuel	1	8.10	
51	R110-8751	110-8751	Hose-Fuel	1	5.30	
52	R110-5701	110-5701, 99-3185, 99-7191	Hose-Fuel	1	8.95	
53	R95-8615	95-8615	Tube-Breather	1	24.15	
Gauges and Controls						
60	R95-8971	95-8971	Guage-Fuel	1	54.10	
Other Parts Available						

All original equipment manufacturers names and part numbers are used for identification purposes only, and we are in no way implying that our products are original equipment parts. Prices subject to change without notice.



Replaces Toro Reelmaster 3550-D Parts

Traction Unit - Model 03910

Hydraulic & Fuel Tank



Item No	R&R Part No.	OEM Part No.	Description	Qty Req	Price Each	Order Quantity
70	R92-2379	92-2379	Clamp - Hose	4	0.41	
71	R304-73	304-73, 307-73, 353-973	Connector-Hose	1	7.50	
72	R354-20	354-20	Fitting-Tee	1	7.50	
73	R354-21	354-21	Fitting-Barb	1	3.65	
74	R354-22	354-22	Fitting-Barb	1	2.45	
75	R2412-108	2412-108, 97406	Clamp - Worm - 1/4 - Stainless	5	2.35	
76	R104-8300	104-8300, 104-8300 , 119-4041	Locknut - 5/16-18 Flanged Y/Zinc	1	0.47	
77	R2412-10	2412-10, Mar-06	R-Clamp	1	4.55	
78	R100-5530	100-5530, 98-0657	Hydraulic Fitting - 45 Deg	1	56.05	
79	R237-58	237-58	O-Ring	2	0.78	
80	R237-81	237-81, 237.81, 327-81	O-Ring	2	2.30	
81	R240-11	240-11	Bushing - Rubber - Flanged	4	2.45	
82	R110-9689	110-9689, R110-9689	Pipe-Stand	1	38.45	
83	R340-101	340-101	Hydraulic Fitting	1	17.15	
84	R237-79	237-79	O-Ring	1	1.50	
85	R237-30	23-6320, 237-30	O-Ring - Seal	1	0.78	

All original equipment manufacturers names and part numbers are used for identification purposes only, and we are in no way implying that our products are original equipment parts. Prices subject to change without notice.



Replaces Toro Reelmaster 3550-D Parts

Traction Unit - Model 03910

Hydraulic & Fuel Tank



Item No	R&R Part No.	OEM Part No.	Description	Qty Req	Price Each	Order Quantity
86	R2412-34	2412-34, 31-0120	Clamp - Hose .75-1.5	2	1.50	
87	R110-0897	110-0897	Cap- Diesel	1	25.50	
88	R95-8620	95-8620	Tank-Fuel	1	229.80	
89	R95-8881	95-8881	Strap - Fuel Line	1	7.95	
90	R321-2	01-150-0200, 01-178-0404, 20-1-AD, 24-2420, 30-4530, 321-2, 32143-9, 513313	Bolt - Hex HD	2	2.55	
91	R95-8968-03	95-8968, 95-8968-03	Support-Tank, Fuel	1	12.05	
92	R46-6550	46-6550	Fitting - Elbow 90	1	21.75	
93	R46-6560	46-6560	Bushing	2	3.55	
94	R32144-10	32140-81, 32144-10, 32144-3, 34-140-AMVD	Bolt - 1/4-20 x 3/4 Serrated Hx Wshr	3	2.85	
95	R104-4840	104-4840	Tank - Hyd	1	877.50	
96	R119-6968	119-6968	Dipstick- Oil	1	26.05	
97	R93-7160	93-3103, 93-7160	Cap - Hyd Oil w/Tether	1	23.45	
98	R63-8410	53-6380, 63-4810, 63-8410	Washer - Isolator Bushing	4	0.77	
99	R3234-11	3234-11	Bolt - Hex Washer HD	4	1.05	
100	R340-136	340-136	O-Ring	1	4.35	

All original equipment manufacturers names and part numbers are used for identification purposes only, and we are in no way implying that our products are original equipment parts. Prices subject to change without notice.



Replaces Toro Reelmaster 3550-D Parts

Traction Unit - Model 03910

Hydraulic & Fuel Tank



Item No	R&R Part No.	OEM Part No.	Description	Qty Req	Price Each	Order Quantity
101	R353-781	353-781	Fitting-Elbow	1	17.35	
102	R353-783	353-783	Fitting - Straight	1	16.15	
103	R340-9	340-9	Fitting - Straight Connector	1	34.55	
104	R3234-13	3234-13, 960151P	Bolt - Flanged Hex 1/4-20	2	0.77	
105	R95-8972	95-8972	Grommet	1	6.30	
106	R2412-72	2412-72	Clip-Closed, Insul	1	0.77	

All original equipment manufacturers names and part numbers are used for identification purposes only, and we are in no way implying that our products are original equipment parts. Prices subject to change without notice.