

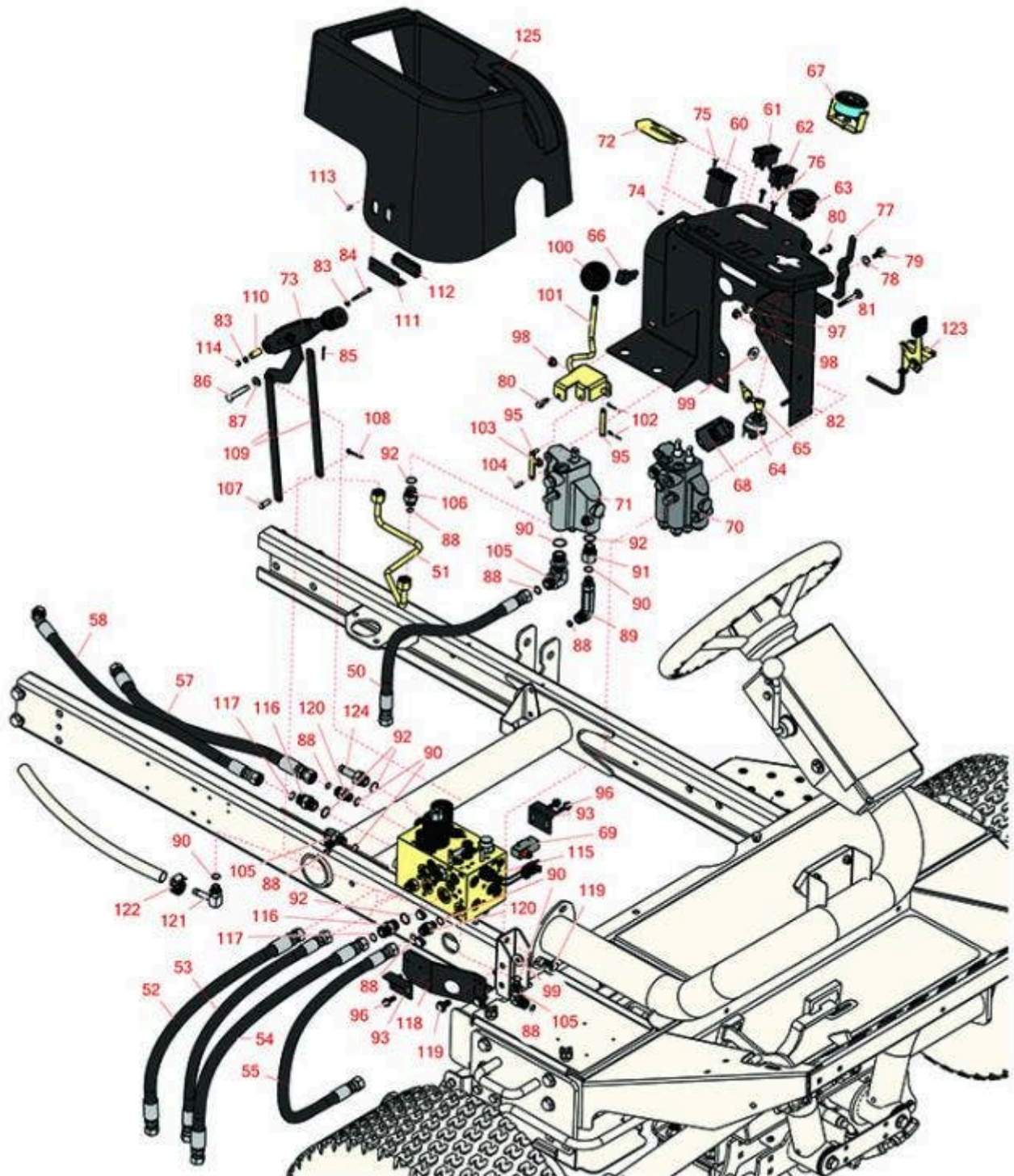

Replaces Toro Reelmaster 3100-D Parts

Traction Unit - Model 03200

Control Panel, Hyd Valve & Parking Brake



All original equipment manufacturers names and part numbers are used for identification purposes only, and we are in no way implying that our products are original equipment parts. Prices subject to change without notice.



Replaces Toro Reelmaster 3100-D Parts

Traction Unit - Model 03200

Control Panel, Hyd Valve & Parking Brake



| Item No | R&R Part No. | OEM Part No. | Description | Qty Req | Price Each | Order Quantity |
|----------------------------|------------------|---|-----------------------------|---------|--------------|----------------|
| Hoses | | | | | | |
| 50 | R99-3575 | 99-3575 | Hydraulic Hose Assy | 1 | 56.20 | |
| 51 | R99-3551 | 99-3551 | Tube Assy | 1 | 64.65 | |
| 52 | R99-3578 | 99-3578 | Hydraulic Hose Assy | 1 | 58.95 | |
| 53 | R99-3577 | 69-5860, 99-3577 | Hydraulic Hose Assy | 1 | 39.55 | |
| 54 | R99-3574 | 99-3574 | Hydraulic Hose Assy | 1 | 71.95 | |
| 55 | R99-3576 | 99-3576 | Hydraulic Hose Assy | 1 | 46.90 | |
| 57 | R95-8829 | 95-8829 | Hydraulic Hose Assy | 1 | 48.60 | |
| 58 | R106-4197 | 106-4197 | Hydraulic Hose Assy | 1 | 57.90 | |
| Gauges and Controls | | | | | | |
| 60 | R75-6820 | 75-6820 | Meter - Hour - Quartz | 1 | 59.85 | |
| 61 | R100-8071 | 100-8071 | Lamp - Warning | 1 | 22.35 | |
| 62 | R100-8070 | 100-8070 | Lamp - Warning | 1 | 22.35 | |
| 63 | R95-8999 | 95-8999 | Switch - Headlight | 1 | 28.80 | |
| 64 | R104-2541 | 104-2541, 88-9830 | Switch - Key 6 Lead 5/8 Mt. | 1 | 18.80 | |
| 65 | R343060 | 218-412, 32-8380, 33-2010, 62-7770, 63-8360, 94-2618 | Ignition - Key Set/2 | 1 | 2.75 | |
| 66 | R100-4918 | 100-4818, 100-4918 | Diode | 1 | 21.70 | |
| 67 | R93-7053 | 87-4140, 93-7053 | Cluster - Lamp Warning | 1 | 98.85 | |

All original equipment manufacturers names and part numbers are used for identification purposes only, and we are in no way implying that our products are original equipment parts. Prices subject to change without notice.



Replaces Toro Reelmaster 3100-D Parts

Traction Unit - Model 03200

Control Panel, Hyd Valve & Parking Brake



| Item No | R&R Part No. | OEM Part No. | Description | Qty Req | Price Each | Order Quantity |
|------------------------------|---------------------|---------------------------------|-------------------------------------|---------|---------------|----------------|
| 68 | RX1709565660 | 98-7611, 99-3463, 99-7611 | Kubota Controller | 1 | 168.60 | |
| 69 | R29-6162 | 29-6161, 29-6162 | Switch - Micro | 1 | 65.45 | |
| 70 | R95-8581 | 95-8581 | Valve- Assy - 2 Spool | 1 | 752.75 | |
| 71 | R95-8689 | 95-8689 | Valve Assy - Control - Single Spool | 1 | 447.05 | |
| Other Parts Available | | | | | | |
| 72 | R104-0421 | 104-0421 | Plate - Throttle Stop | 1 | 8.15 | |
| 73 | R104-4817 | 104-4817 | Lever - Brake | 1 | 92.30 | |
| 74 | R3290-148 | 3290-148 | Nut - 10-24 Fl Lock | 2 | 0.36 | |
| 75 | R32144-18 | 32144-18 | Screw - Hex HD | 2 | 1.90 | |
| 76 | R32105-13 | 32105-13 | Screw - Hx Was HD 10-32 x 3/4 | 2 | 1.05 | |
| 77 | R99-3401-03 | 99-3401, 99-3401-03 | Lever - Valve - Lock | 1 | 9.65 | |
| 78 | R3290-477 | 108473, 3290-477 | Washer - Spring Wave | 1 | 0.75 | |
| 79 | R63-3410 | 63-3410 | Screw - Shoulder | 1 | 4.50 | |
| 80 | R42-3560 | 42-3560 | Bolt-Shoulder | 2 | 4.35 | |
| 81 | R3230-33 | 3230-33 | Screw - Carriage | 2 | 2.55 | |
| 82 | R104-5190-03 | 104-5190-03 | Panel - Control | 1 | 177.05 | |
| 83 | R150426 | 3256-21 | Washer - 8 SAE | 2 | 0.23 | |
| 84 | R32105-9 | 32105-9 | Screw | 1 | 0.87 | |

All original equipment manufacturers names and part numbers are used for identification purposes only, and we are in no way implying that our products are original equipment parts. Prices subject to change without notice.



Replaces Toro Reelmaster 3100-D Parts

Traction Unit - Model 03200

Control Panel, Hyd Valve & Parking Brake



| Item No | R&R Part No. | OEM Part No. | Description | Qty Req | Price Each | Order Quantity |
|---------|-----------------|--|----------------------------|---------|--------------|----------------|
| 85 | R1023-4 | 01-151-0150, 1023-4, 19-6220, 214-14, 215-54, 28-9-D, 3272-4, 3272-6, 513567, 932008P | Pin - Cotter 3/32 x 3/4 | 1 | 0.23 | |
| 86 | R94-3829 | 94-3829 | Pin - Clevis | 1 | 2.55 | |
| 87 | R453009 | 01-166-0400, 24-10-BD, 24-9-AD, 32-9650, 3256-2, 3256-23, 3256-3, 3256-67, 3290-217, 3556-3, 4-2390, 7-0152 | Washer - Flat 5/16 SAE | 1 | 0.13 | |
| 88 | R237-22 | 107-8844, 237-22, 237-78 | O-Ring | 5 | 0.62 | |
| 89 | R69-4320 | 69-4320 | Hydraulic Fitting - 90 Deg | 1 | 96.05 | |
| 90 | R237-42 | 237-42, 31-4160 | O-Ring | 4 | 0.80 | |
| 91 | R353-397 | 353-397 | Reducer - Adapter | 1 | 4.65 | |
| 92 | R237-79 | 237-79 | O-Ring | 4 | 1.50 | |
| 93 | R95-8765 | 95-8765 | Bracket - Magnet Strike | 2 | 6.05 | |
| 95 | R95-8634 | 95-8634 | Link | 2 | 2.95 | |

All original equipment manufacturers names and part numbers are used for identification purposes only, and we are in no way implying that our products are original equipment parts. Prices subject to change without notice.



Replaces Toro Reelmaster 3100-D Parts

Traction Unit - Model 03200

Control Panel, Hyd Valve & Parking Brake



| Item No | R&R Part No. | OEM Part No. | Description | Qty Req | Price Each | Order Quantity |
|---------|------------------|---|---------------------------------------|---------|--------------|----------------|
| 96 | R32144-10 | 32140-81, 32144-10, 32144-3, 34-140-AMVD | Bolt - 1/4-20 x 3/4 Serrated Hx Wshr | 4 | 2.85 | |
| 97 | R3256-22 | 24-9-BD, 3-1032, 3256-1, 3256-22, 93-0954, 93-0989 | Washer - Flat 1/4 Yellow | 1 | 0.12 | |
| 98 | R32128-32 | 32128-32 | Locknut - 1/4-20 Flanged | 3 | 1.35 | |
| 99 | R32128-43 | 30-8990, 32128-43, 3290-357 | Nut - Flanged Whiz - 3/8-16 | 6 | 0.62 | |
| 100 | R233-42 | 1-603175, 120-9752, 233-42, 233-47 | Knob | 1 | 6.80 | |
| 101 | R95-8692 | 95-8692 | Lever Assy | 1 | 75.50 | |
| 102 | R3272-5 | 28-8-D, 3272-5 | Pin-Cotter | 2 | 2.30 | |
| 103 | R32128-33 | 32128-33 | Nut - 1/4-20 Flanged Serr | 2 | 0.70 | |
| 104 | R58-3830 | 58-3830 | Pin - Clevis 3/16 x 3/4 | 2 | 7.50 | |
| 105 | R340-77 | 340-100, 340-77, 95-7889 | Hydraulic Fitting | 3 | 15.85 | |
| 106 | R340-3 | 340-3 | Hydraulic Fitting - Adapter Connector | 1 | 8.05 | |
| 107 | R283-62 | 283-62 | Pin - Clevis 5/16 x 3/4 | 1 | 0.74 | |
| 108 | R3272-10 | 01-151-0120, 105-7512, 3272-10, N/A | Pin - Cotter 1/8 x 3/4 | 1 | 0.13 | |

All original equipment manufacturers names and part numbers are used for identification purposes only, and we are in no way implying that our products are original equipment parts. Prices subject to change without notice.



Replaces Toro Reelmaster 3100-D Parts

Traction Unit - Model 03200

Control Panel, Hyd Valve & Parking Brake



| Item No | R&R Part No. | OEM Part No. | Description | Qty Req | Price Each | Order Quantity |
|---------|---------------------|---|---|---------|----------------|----------------|
| 109 | R104-4628-03 | 104-4628-03 | Link - Parking Brake | 2 | 11.70 | |
| 110 | R87-4710 | 87-4710 | Spacer - Parking Brake | 1 | 3.95 | |
| 111 | R95-8763 | 95-8763 | Bracket - Hold Down | 2 | 8.95 | |
| 112 | R58-4250 | 58-4250, 99-3497 | Catch - Magnetic | 2 | 25.80 | |
| 113 | R3269-5 | 3269-5 | Rivet - Pop | 4 | 0.64 | |
| 114 | R3296-9 | 32127-17, 3296-9 | Locknut - Comb | 1 | 0.34 | |
| 115 | R108-9037 | 104-4841, 108-9037 | Manifold - Reel Drive | 1 | 1530.65 | |
| 116 | R340-4 | 340-4 | Hydraulic Fitting - Male Connector | 2 | 7.95 | |
| 117 | R237-30 | 23-6320, 237-30 | O-Ring - Seal | 2 | 0.78 | |
| 118 | R95-8764-03 | 95-8764, 95-8764-03 | Support - Magnet | 1 | 21.75 | |
| 119 | R3234-1 | 321-11, 3234-1 | Bolt - Flanged Serrated Hex HD 3/8-16 x 3/4 | 6 | 1.45 | |
| 120 | R340-2 | 340-2, 60-1920 | Hydraulic Fitting - Striaght | 2 | 6.50 | |
| 121 | R100-4887 | 100-4887 | Fitting-Barb | 1 | 13.65 | |
| 122 | R2412-36 | 2210-87, 2412-36, 31-9140, 93-5818, 99-0772 | Clamp - Hose 1/2 | 2 | 2.75 | |
| 123 | R110-8750 | 110-8750, 95-8855 | Throttle Control | 1 | 35.55 | |
| 124 | R354-121 | 354-121, 92-1665 | Fitting-Straight | 1 | 10.95 | |

All original equipment manufacturers names and part numbers are used for identification purposes only, and we are in no way implying that our products are original equipment parts. Prices subject to change without notice.



Replaces Toro Reelmaster 3100-D Parts

Traction Unit - Model 03200

Control Panel, Hyd Valve & Parking Brake



| Item No | R&R Part No. | OEM Part No. | Description | Qty Req | Price Each | Order Quantity |
|---------|-----------------|--------------|--------------|---------|---------------|----------------|
| 125 | R95-8707 | 95-8707 | Cover - Dash | 1 | 106.65 | |

All original equipment manufacturers names and part numbers are used for identification purposes only, and we are in no way implying that our products are original equipment parts. Prices subject to change without notice.