

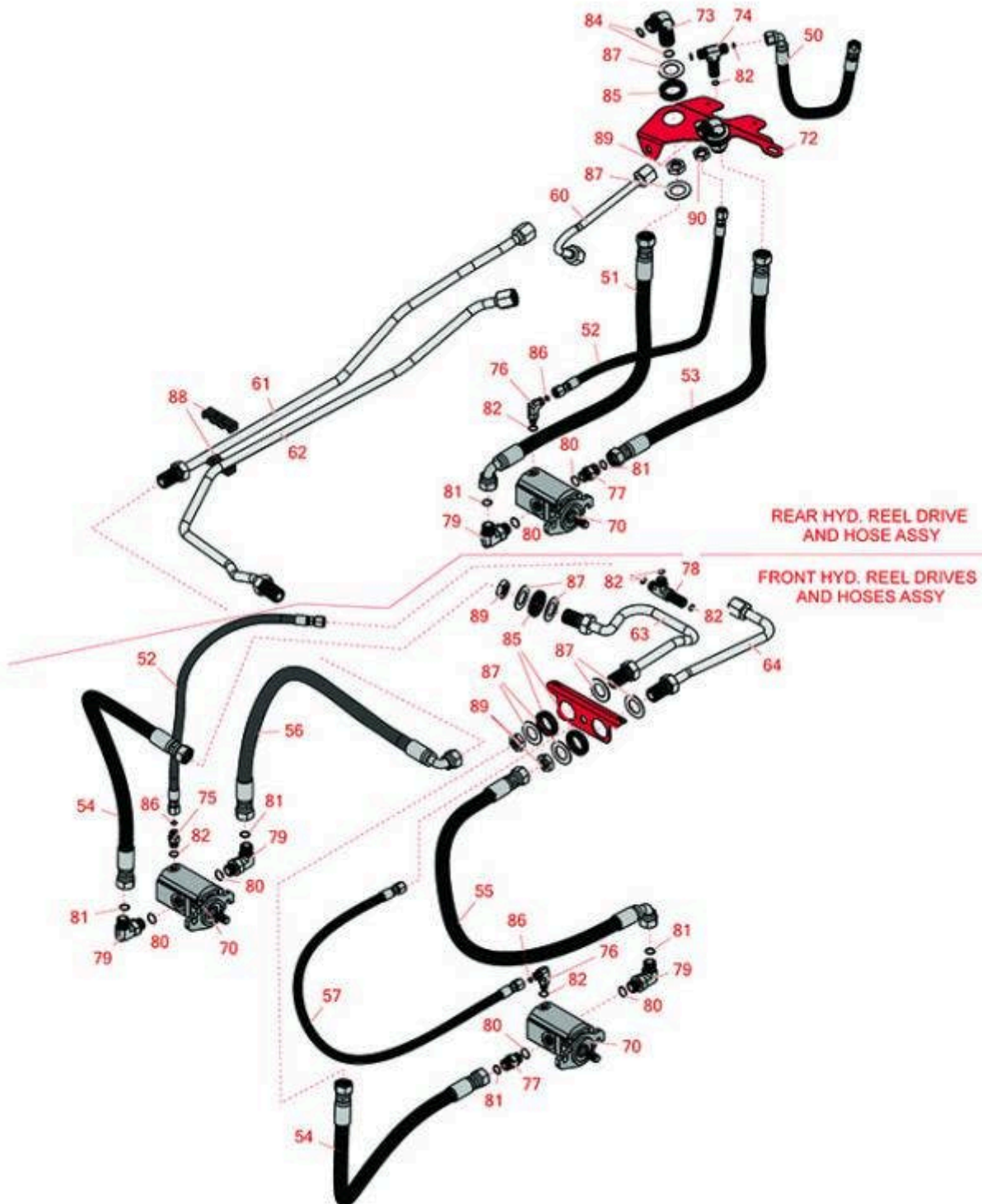

# Replaces Toro Greensmaster 3120 Parts

Traction Unit  
Hydraulics



All original equipment manufacturers names and part numbers are used for identification purposes only, and we are in no way implying that our products are original equipment parts. Prices subject to change without notice.



# Replaces Toro Greensmaster 3120 Parts

*Traction Unit  
Hydraulics*



| Item No                      | R&R Part No.        | OEM Part No.  | Description                      | Qty Req | Price Each    | Order Quantity |
|------------------------------|---------------------|---|----------------------------------|---------|---------------|----------------|
| <b>Hoses</b>                 |                     |   |                                  |         |               |                |
| 50                           | <b>R105-5409</b>    | 105-5409  | Hydraulic Hose Assy              | 1       | <b>67.65</b>  |                |
| 51                           | <b>R105-5401</b>    | 105-5401  | Hydraulic Hose Assy              | 1       | <b>86.85</b>  |                |
| 52                           | <b>R105-5402</b>    | 105-5402  | Hydraulic Hose Assy              | 1       | <b>46.75</b>  |                |
| 53                           | <b>R105-5400</b>    | 105-5400  | Hydraulic Hose Assy              | 1       | <b>80.40</b>  |                |
| 54                           | <b>R95-2908</b>     | 105-5403,<br>93-2262,<br>95-2908                            | Hydraulic Hose Assy - Reel Motor | 2       | <b>86.10</b>  |                |
| 55                           | <b>R95-2909</b>     | 93-2263,<br>95-2909   | Hydraulic Hose Assy - Reel Motor | 1       | <b>86.45</b>  |                |
| 56                           | <b>R105-5404</b>    | 105-5404  | Hydraulic Hose Assy              | 1       | <b>106.45</b> |                |
| 57                           | <b>R106-9674</b>    | 106-9674  | Hydraulic Hose Assy              | 1       | <b>39.20</b>  |                |
| 60                           | <b>R105-5482</b>    | 105-5482  | Tube-Hyd, Manifold               | 1       | <b>59.95</b>  |                |
| 61                           | <b>R105-5493</b>    | 105-5493  | Tube-Hyd                         | 1       | <b>75.85</b>  |                |
| 62                           | <b>R107-2582</b>    | 107-2582  | Tube-Hyd                         | 1       | <b>71.45</b>  |                |
| 63                           | <b>R107-2580</b>    | 107-2580  | Tube-Hyd                         | 1       | <b>75.60</b>  |                |
| 64                           | <b>R107-2581</b>    | 107-2581  | Tube-Hyd                         | 1       | <b>56.80</b>  |                |
| <b>Other Parts Available</b> |                     |   |                                  |         |               |                |
| 70                           | <b>R120-2072</b>    | 100-6426,<br>108-6487,<br>112-9200,<br>120-2072,<br>93-1375 | Hydraulic Gear Motor             | 3       | <b>360.90</b> |                |
| 72                           | <b>R105-8253-01</b> | 105-8253-01   | Bracket - Bulkhead               | 1       | <b>38.75</b>  |                |
| 73                           | <b>R340-72</b>      | 340-72,<br>96-0865  | Fitting-Bulkhead,                | 2       | <b>27.90</b>  |                |

All original equipment manufacturers names and part numbers are used for identification purposes only, and we are in no way implying that our products are original equipment parts. Prices subject to change without notice.



# Replaces Toro Greensmaster 3120 Parts

*Traction Unit  
Hydraulics*



| Item No | R&R Part No.     | OEM Part No.                   | Description                        | Qty Req | Price Each   | Order Quantity |
|---------|------------------|--------------------------------|------------------------------------|---------|--------------|----------------|
| 74      | <b>R105-8281</b> | 105-8281                       | Tee-Bulkhead                       | 1       | <b>45.75</b> |                |
| 75      | <b>R340-92</b>   | 340-92                         | Hydraulic Fitting - Striaight      | 1       | <b>6.95</b>  |                |
| 76      | <b>R340-132</b>  | 340-132                        | Hydraulic Fitting - 90 Deg         | 4       | <b>14.40</b> |                |
| 77      | <b>R340-4</b>    | 340-4                          | Hydraulic Fitting - Male Connector | 2       | <b>7.95</b>  |                |
| 78      | <b>R340-68</b>   | 340-120,<br>340-68             | Fitting - Tee - Bulkhead           | 1       | <b>19.20</b> |                |
| 79      | <b>R340-98</b>   | 340-98                         | Hydraulic Fitting                  | 8       | <b>15.60</b> |                |
| 80      | <b>R237-79</b>   | 237-79                         | O-Ring                             | 6       | <b>1.50</b>  |                |
| 81      | <b>R237-30</b>   | 23-6320,<br>237-30             | O-Ring - Seal                      | 6       | <b>0.78</b>  |                |
| 82      | <b>R237-22</b>   | 107-8844,<br>237-22,<br>237-78 | O-Ring                             | 8       | <b>0.62</b>  |                |
| 84      | <b>R237-65</b>   | 237-65,<br>237.65              | O-Ring                             | 2       | <b>0.65</b>  |                |
| 85      | <b>R240-3</b>    | 240-3                          | Grommet- Rubber                    | 4       | <b>9.60</b>  |                |
| 86      | <b>R237-21</b>   | 237-21,<br>327-21              | O-Ring                             | 3       | <b>0.47</b>  |                |
| 87      | <b>R69-9010</b>  | 69-9010,<br>9-9010             | Washer                             | 10      | <b>2.40</b>  |                |
| 88      | <b>R93-2509</b>  | 93-2509                        | Clamp - Tube                       | 2       | <b>6.25</b>  |                |
| 89      | <b>R340-74</b>   | 340-74                         | Locknut - Bulkhead                 | 5       | <b>5.05</b>  |                |
| 90      | <b>R340-70</b>   | 340-70                         | Nut - Lock                         | 1       | <b>2.30</b>  |                |

All original equipment manufacturers names and part numbers are used for identification purposes only, and we are in no way implying that our products are original equipment parts. Prices subject to change without notice.