



Replaces R&R Products Versa-Green

2160D Parts

Traction Unit

Control Valve

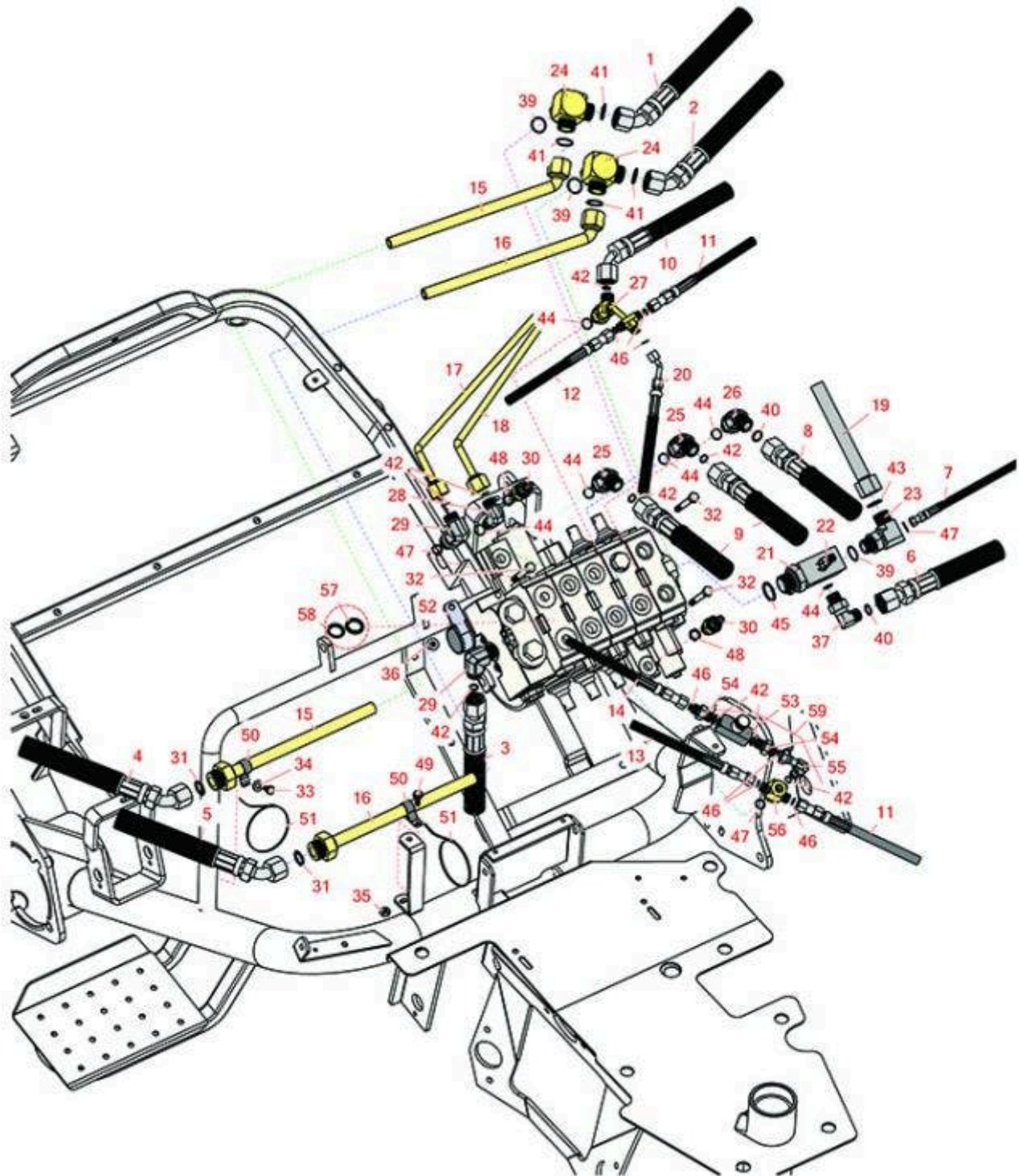

All original equipment manufacturers names and part numbers are used for identification purposes only, and we are in no way implying that our products are original equipment parts. Prices subject to change without notice.



Replaces R&R Products Versa-Green

2160D Parts

Traction Unit
Control Valve



Item No	R&R Part No.	OEM Part No.	Description	Qty Req	Price Each	Order Quantity
Hoses						
1	R150627		Hydraulic Hose Assy - Drive Motor - RH Upper	1	102.45	
2	R150641		Hydraulic Hose Assy - Drive Motor - RH Lower	1	101.75	
3	R150644		Hydraulic Hose Assy - Valve to Pump	1	38.45	
4	R150645		Hydraulic Hose Assy - Drive Motor - LH Upper	1	95.60	
5	R150642		Hydraulic Hose Assy - Drive Motor - LH Lower	1	102.45	
6	R150631		Hose - Rear Motor Return	1	41.75	
7	R150636		Hydraulic Hose Assy - Steering Cylinder	1	52.95	
8	R150626		Hydraulic Hose Assy - Valve to Pump	1	41.75	
9	R150620		Hydraulic Hose Assy - Valve to Pump	2	33.80	
10	R150633		Hydraulic Hose Assy - Rear Pressure	1	60.95	
11	R150640		Hydraulic Hose Assy - RH Lift Cylinder	1	31.45	
12	R150632		Hose - Cyl LH Drop Fits	1	35.60	
13	R150638		Hydraulic Hose Assy - Front LH Cylinder	1	30.90	
14	R150639		Hydraulic Hose Assy - Rear Lift Cylinder	3	35.30	
15	R70-7130		Line - Tube	1	83.45	

All original equipment manufacturers names and part numbers are used for identification purposes only, and we are in no way implying that our products are original equipment parts. Prices subject to change without notice.



Replaces R&R Products Versa-Green

2160D Parts

Traction Unit
Control Valve



Item No	R&R Part No.	OEM Part No.	Description	Qty Req	Price Each	Order Quantity
16	R83-1200		Tube - LH Lower Traction	1	63.10	
17	R63-4020		Tube - Hyd	1	102.80	
18	R63-4030		Tube - Hyd	1	90.90	
19	R100-6431	R63-4040	Tube - Return	1	126.85	
20	R150637		Hose - Rear Lift Cyl	1	38.95	

Other Parts Available

21	R68-5260		Fitting - Valve Manifold - P Steer	1	149.85	
22	R340-103	R340-137	Hydraulic Fitting - 45 Deg	1	18.15	
23	R340-16	R100-8255	Hydraulic Fitting	1	27.10	
24	R63-4050		Hydraulic Fitting	2	65.65	
25	R340-138		Hydraulic Fitting	2	17.15	
26	R340-101		Hydraulic Fitting	1	17.15	
27	R83-1670		Fitting Assy - Special	1	62.95	
28	R340-18		Hydraulic Fitting	1	20.95	
29	R340-77	R340-100, R95-7889	Hydraulic Fitting	2	15.85	
30	R83-1890		Ball Switch - Control Valve	2	29.10	
31	R150646		Seal - Flat	2	4.55	
32	R322-14	R01-150-0830, R01-178-0524, R30-8900	Bolt - Hex HD 5/16-18 x 3 GR5	3	2.15	
33	R12-3270	R30-0700, R32104-17, R8-3880, R9266714	Bolt - Hex Washer 1/4-20 x 1/2	1	1.45	

All original equipment manufacturers names and part numbers are used for identification purposes only, and we are in no way implying that our products are original equipment parts. Prices subject to change without notice.



Replaces R&R Products Versa-Green

2160D Parts

*Traction Unit
Control Valve*



Item No	R&R Part No.	OEM Part No.	Description	Qty Req	Price Each	Order Quantity
34	R3256-22	R09061, R24-9-BD, R3-1032, R93-0954, R93-0989	Washer - Flat 1/4 Yellow	1	0.12	
35	R301504	R32127-24, R32146-17, R3296-16, R3296-42, R915661P, RM40333	Locknut - ESNA 1/4-20	1	0.18	
36	R445722	R30-8980, R32128-2, R32128-20	Nut - Serrated Washer	3	0.66	
37	R150290		Hydraulic Fitting - 90 Deg	1	24.15	
39	R237-80	R327-80	O-Ring	3	1.85	
40	R237-30	R23-6320	O-Ring - Seal	2	0.78	
41	R237-65		O-Ring	4	0.65	
42	R237-22	R107-8844, R232-72, R237-78	O-Ring	5	0.62	
43	R237-58		O-Ring	1	0.78	
44	R237-79		O-Ring	6	1.50	
45	R237-81		O-Ring	1	2.30	
46	R237-21		O-Ring	8	0.47	
47	R237-42	R31-4160, R339897	O-Ring	4	0.80	
48	R38-0410		Nut - Hex - 9/16-18 Thin-SS	2	3.45	
49	R3234-4		Bolt - Hx Ser Was HD 1/4-20 x 3/4	1	0.67	

All original equipment manufacturers names and part numbers are used for identification purposes only, and we are in no way implying that our products are original equipment parts. Prices subject to change without notice.



Replaces R&R Products Versa-Green

2160D Parts

Traction Unit
Control Valve



Item No	R&R Part No.	OEM Part No.	Description	Qty Req	Price Each	Order Quantity
50	R2412-41		Clamp	2	4.80	
51	R3M41939		Cable Ties - 8" Bulk Pkg/100	2	32.80	
52	R304-61		Clamp - Hose	1	6.05	
53	R150837		Flow Control	1	131.95	
54	R340-92		Hydraulic Fitting - Striaght	2	6.95	
55	R150839		Hydraulic Fitting - 90 Deg	1	21.40	
56	R150838		Fitting - Special	1	66.90	
57	R353-957		Lip Seal - Control Valve	1	12.05	
58	R92-2546		Wiper Seal - Control Valve	1	3.40	
59	R150296		Valve Assy	1	227.15	

Tech Note: Includes: R150299 Fitting, R150839 Fitting, R340-92 Fitting, R150837 Flow Control, R237-42 O-Ring, R237-21 O-Ring & R237-22 O-Ring:

All original equipment manufacturers names and part numbers are used for identification purposes only, and we are in no way implying that our products are original equipment parts. Prices subject to change without notice.