



Replaces R&R Products Sand Max 416

Parts

Attachments

Weeder Tine Toolbar

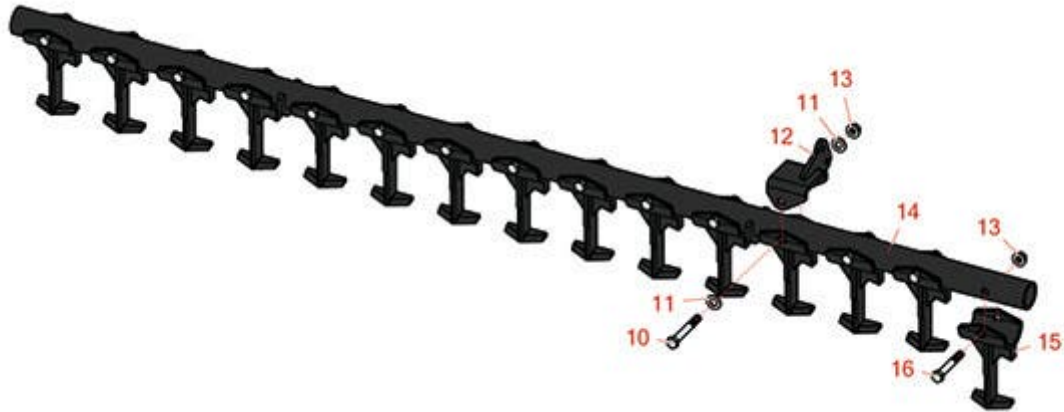

All original equipment manufacturers names and part numbers are used for identification purposes only, and we are in no way implying that our products are original equipment parts. Prices subject to change without notice.



Replaces R&R Products Sand Max 416 Parts

Attachments

Weeder Tine Toolbar



| Item No | R&R Part No. | OEM Part No. | Description | Qty Req | Price Each | Order Quantity |
|---------|---------------------|---|------------------------------|---------|---------------|----------------|
| 10 | R323-14 | 323-14, R01-150-0840, R01-178-0624, R20-55-AD, R21-196-AMD, R30-8750, R30-8970, R3224-10 | Bolt - Hex HD 3/8-16 x 3 | 1 | 2.05 | |
| 11 | R453011 | 3256-24, 453011, R01-166-0100, R01-166-0120, R01-166-0270, R01-166-0500, R01-166-0600, R01-166-0620, R132-4593, R237-12, R24-10-AD, R24-11-AD, R24-11-BD, R24-12-AD, R24-12-BD, R30-9310, R32-8190, R3256-24, R3256-3, R3256-36, R3256-4, R47-9950 | Washer - Flat 3/8 SAE Y/Zinc | 2 | 0.12 | |
| 12 | R112-6468-03 | | Bracket Assy - Tool Bar | 1 | 31.95 | |
| 13 | R3296-39 | 3296-39, R32127-25, R32128-36, R3296-17, R3296-22, R915663P, R99-7443 | Locknut - 3/8-16 Nylon | 15 | 1.50 | |
| 14 | R108-4527-03 | | Tool Bar Assy | 1 | 355.15 | |
| 15 | R110-0260-03 | | Weeder Tine - Hardened | 15 | 45.20 | |

All original equipment manufacturers names and part numbers are used for identification purposes only, and we are in no way implying that our products are original equipment parts. Prices subject to change without notice.



Replaces R&R Products Sand Max 416 Parts

Attachments

Weeder Tine Toolbar



| Item No | R&R Part No. | OEM Part No. | Description | Qty Req | Price Each | Order Quantity |
|---------|--------------|---|----------------------------------|---------|------------|----------------|
| 16 | R400274 | R01-178-0626, R112-7161, R3224-11, R323-20 | Bolt - Hex HD 3/8-16 x 2-1/2 GR5 | 14 | 1.60 | |

All original equipment manufacturers names and part numbers are used for identification purposes only, and we are in no way implying that our products are original equipment parts. Prices subject to change without notice.