

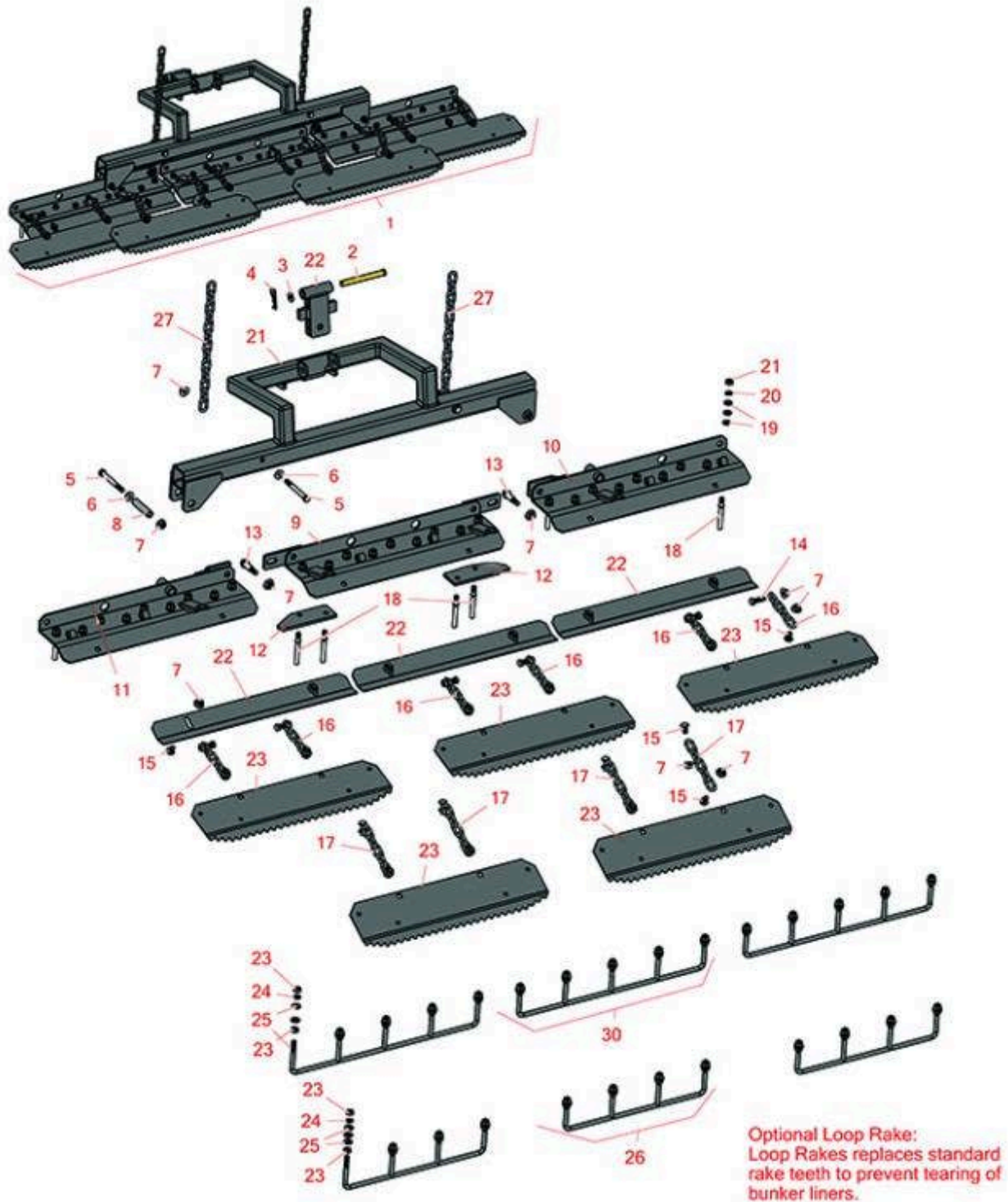

Replaces R&R Products Sand Max 216

Parts

Attachments
Tooth Rake

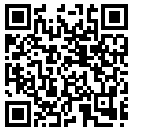

All original equipment manufacturers names and part numbers are used for identification purposes only, and we are in no way implying that our products are original equipment parts. Prices subject to change without notice.



Replaces R&R Products Sand Max 216

Parts

Attachments

Tooth Rake



Item No	R&R Part No.	OEM Part No.	Description	Qty Req	Price Each	Order Quantity
---------	--------------	--------------	-------------	---------	------------	----------------

Complete Kits Available

1	R08812	08812	Tooth Rake to Fit Standard Mounting Hitch	1	1109.65	
---	---------------	-------	---	---	----------------	--

Other Parts Available

2	R283-83	283-83, R42194, R93-5343	Pin - Clevis	1	5.15	
---	----------------	--------------------------------	--------------	---	-------------	--

3	R187-0	3256-25, R3256-25, R7-0032	Washer - Flat 7/16 SAE	1	0.22	
---	---------------	----------------------------------	------------------------	---	-------------	--

4	R3272-12	3272-12, R01-151-0090, R28-19-D	Pin - Cotter 1/8 x 1-1/4	1	0.11	
---	-----------------	---------------------------------------	--------------------------	---	-------------	--

4	R460312	R30-8530, R3290-343, R460316	Pin - Hair Cotter	1	0.69	
---	----------------	------------------------------------	-------------------	---	-------------	--

5	R323-14	323-14, R01-150-0840, R01-178-0624, R20-55-AD, R21-196-AMD, R30-8750, R30-8970, R3224-10	Bolt - Hex HD 3/8-16 x 3	2	1.95	
---	----------------	---	--------------------------	---	-------------	--

6	R453009	3256-3, R01-166-0400, R24-10-BD, R24-9-AD, R24H1136, R32-9650, R3256-2, R3256-23, R3256-67, R3290-217, R3556-3, R4-2390, R452006, R7-0152	Washer - Flat 5/16 SAE	2	0.13	
---	----------------	--	------------------------	---	-------------	--

All original equipment manufacturers names and part numbers are used for identification purposes only, and we are in no way implying that our products are original equipment parts. Prices subject to change without notice.



Replaces R&R Products Sand Max 216

Parts

Attachments

Tooth Rake



Item No	R&R Part No.	OEM Part No.	Description	Qty Req	Price Each	Order Quantity
6	R310266	3256-3, R09056, R452004	Washer - Flat 5/16 USS	2	0.23	
7	R32128-21	32128-21	Locknut - Flanged 3/8-16 Whiz Top Lock	30	0.55	
8	R84-2350	84-2350	Spacer - Rake Frame	2	4.95	
9	R84-2390-03	84-2390, 84-2390-03, R84-2390	Plate - Center Trowel	1	95.45	
10	R84-2400-03	84-2400, 84-2400-03, R84-2400	Plate - RH Trowel	1	95.35	
11	R84-2360-03	84-2360, 84-2360-03, R84-2360	Plate - LH Trowel	1	95.35	
12	R88-8440-03	88-8440-03, R256-289	Plate - Tipper	2	7.90	
13	R66-0561	66-0561	Screw - Shoulder	2	6.75	
14	R400264	323-7, R01-150-0180, R01-178-0610, R19H1732, R20-48-AD, R20-48-AGD, R32-9160, R3224-3, R323-29, R323-7, R400264, R908035P	Bolt - Hex HD 3/8-16 x 1-1/4	6	0.40	
15	R3231-21	3231-21	Screw - 3/8-16 x 3/4 Carriage	20	0.75	
16	R84-2450	84-2450	Chain - Straight 4	6	4.55	
17	R84-2451	84-2451	Chain - Straight 5	4	4.75	

All original equipment manufacturers names and part numbers are used for identification purposes only, and we are in no way implying that our products are original equipment parts. Prices subject to change without notice.



Replaces R&R Products Sand Max 216

Parts

Attachments

Tooth Rake



Item No	R&R Part No.	OEM Part No.	Description	Qty Req	Price Each	Order Quantity
18	R88-8450	88-8450, RTCU20088	Tooth - Rake 3-3/8 Oal	27	3.20	
18	R42-1940	42-1940, R84-2590, R85-0280	Tooth - Rake 4-3/8 Oal	27	2.95	
19	R84-2550-03	84-2550, 84-2550-03, R84-2550	Trowel - Smooth	3	11.80	
20	R84-2280	84-2280, 84-2280-03, R84-2280-01, R84-2280-03	Rake - Finishing	5	17.75	
21	R84-2680-03	84-2680, 84-2680-03, R84-2680	Hanger Assy	1	264.50	
22	R84-2230-03	84-2230, 84-2230-03, R84-2230	Pivot Assy	1	31.15	
23	R3217-7	3217-7, R01-188-0616, R1441, R14H1076, R22-13-AJD, R513296, R513415, R513425, R915113P	Nut - 3/8-16 Hex Plated	27	0.24	
24	R3253-21	3253-21, R215-51, R30-8470, R7-1912, RMT3949	Washer - Lock 3/8	27	0.14	

All original equipment manufacturers names and part numbers are used for identification purposes only, and we are in no way implying that our products are original equipment parts. Prices subject to change without notice.



Replaces R&R Products Sand Max 216

Parts

Attachments

Tooth Rake

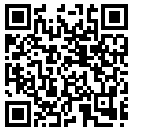

Item No	R&R Part No.	OEM Part No.	Description	Qty Req	Price Each	Order Quantity
25	R453011	3256-24, 453011, R01-166-0100, R01-166-0120, R01-166-0270, R01-166-0500, R01-166-0600, R01-166-0620, R132-4593, R237-12, R24-10-AD, R24-11-AD, R24-11-BD, R24-12-AD, R24-12-BD, R30-9310, R32-8190, R3256-24, R3256-3, R3256-36, R3256-4, R47-9950	Washer - Flat 3/8 SAE Y/Zinc	81	0.11	
26	R84-2452	84-2452	Chain - 14 Link, Str	2	7.95	
30	R150850		Rake - Front Loop 19	3	59.05	
31	R150851		Rake - Rear Loop 14.25	3	53.05	

Tech Note: Loop rakes avoid tearing of sand trap liners:

All original equipment manufacturers names and part numbers are used for identification purposes only, and we are in no way implying that our products are original equipment parts. Prices subject to change without notice.