

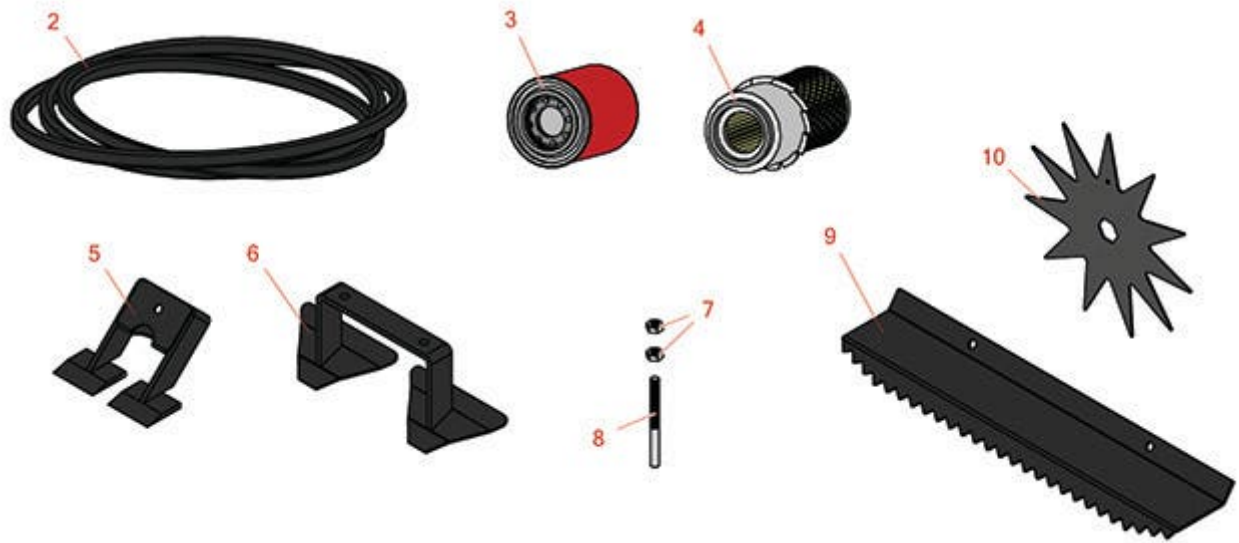

# Replaces Jacobsen Groom Master Parts

Traction Unit  
Traction Unit



All original equipment manufacturers names and part numbers are used for identification purposes only, and we are in no way implying that our products are original equipment parts. Prices subject to change without notice.



# Replaces Jacobsen Groom Master Parts

Traction Unit  
Traction Unit



Item No	R&R Part No.	OEM Part No.	Description	Qty Req	Price Each	Order Quantity
<b>Belts</b>						
2	<b>R838007</b>	838007	Belt	1	<b>68.90</b>	
<b>Filters</b>						
3	<b>R86-3010</b>	108046, 281370, 522972, 549587, 549597, 925023	Baldwin Hydraulic Oil Filter	1	<b>10.65</b>	
3	<b>RRF10611</b>	118017, 885249	SilverGuard Hydraulic Oil Filter	1	<b>8.75</b>	
4	<b>R33-1300</b>	148077, 502619, 838558	Baldwin Filter - Air Element	1	<b>24.85</b>	
4	<b>RRF10201</b>	148077, 502619, 838558	SilverGuard Air Filter	1	<b>15.55</b>	
<b>Other Parts Available</b>						
5	<b>R891777</b>	891777	Scarifier Knife	10	<b>37.60</b>	
6	<b>R891256</b>	891256	Cultivator Blade	5	<b>46.85</b>	
7	<b>R443110</b>	306562, 443110, 444762	Nut - 3/8-16 Hex	54	<b>0.15</b>	
8	<b>R546617</b>	546617, 837920	Stud - Rake Teeth	27	<b>2.35</b>	
9	<b>R837927</b>	837927	Rake - Drag	5	<b>39.70</b>	
10	<b>R520180</b>	520180	Spiker Blade - 10 in. 14 GA.	28	<b>13.35</b>	

All original equipment manufacturers names and part numbers are used for identification purposes only, and we are in no way implying that our products are original equipment parts. Prices subject to change without notice.