

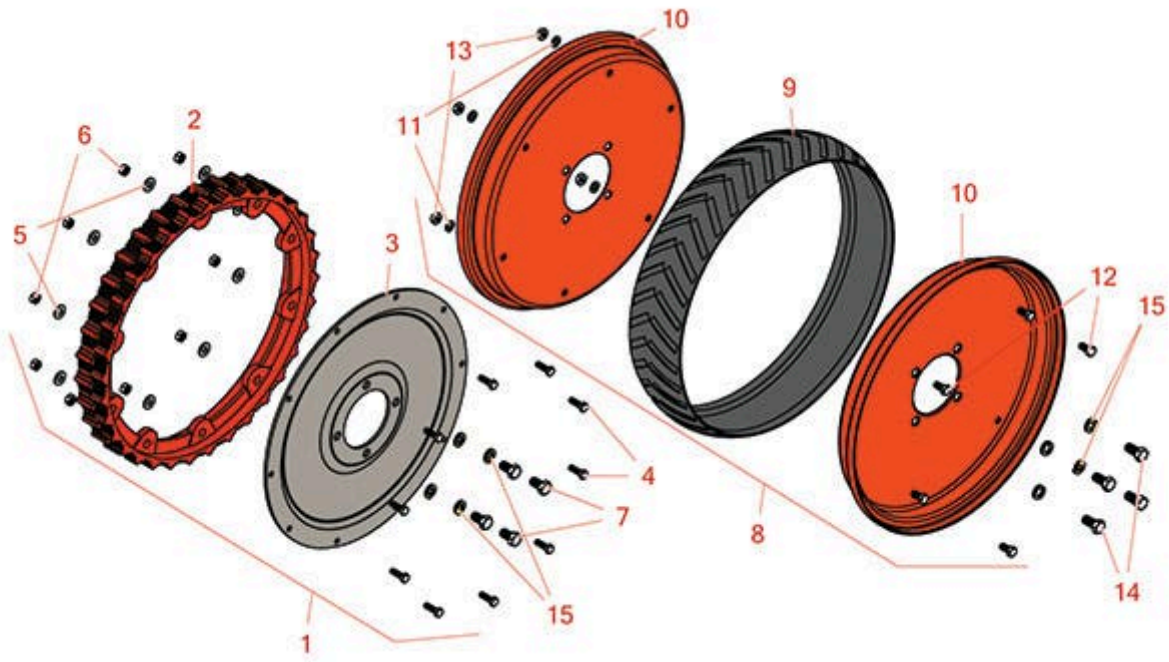

Replaces Jacobsen Blitzer Parts

Cutting Unit
Tires & Wheels



All original equipment manufacturers names and part numbers are used for identification purposes only, and we are in no way implying that our products are original equipment parts. Prices subject to change without notice.



Replaces Jacobsen Blitzer Parts

Cutting Unit
Tires & Wheels



Item R&R
No Part No.

OEM
Part No. Description

Qty
Req

Price
Each

Order
Quantity

Steel Wheels

1	R101425		Wheel - 18 w/ Disc Assy (2 Ea)	1	421.40
2	R203987	203987	Wheel - 18 Rim 18 O.D.	2	143.10
3	R315938	315938	Disc - 18 Wheel	2	77.80
4	R400226	400226	Bolt - Hex HD 5/16-24 x 1	20	0.47
5	R310266	310266, 452004, 452006, 452008	Washer - Flat 5/16 USS	20	0.23
6	R444754	444754	Locknut - 5/16-24 Center	20	0.43
7	R400436	400436	Bolt - Hex HD 1/2-20 x 7/8	8	0.67

Semi-Pneumatic Wheels

8	R70097	70097	Wheel Assy - 4x20 (2 Ea) 20 O.D.	1	412.45
9	R316482	316482	Tire - 4x20 Semi Pneumatic 20 in OD	2	68.95
10	R336054	336054	Disc - Half 4x20 - 17 O.D.	4	67.20
11	R3254-6	3254-6, 446140, 446142	Washer - Lock 3/8	12	0.08
12	R400258	400258	Bolt - Hex HD 3/8-16 x 3/4	12	0.51
13	R443110	306562, 443110, 444762	Nut - 3/8-16 Hex	12	0.14
14	R400438	400438	Bolt - Hex HD 1/2-20 x 1	8	0.79
15	R446154	446152, 446154	Washer - Lock 1/2	8	0.26

All original equipment manufacturers names and part numbers are used for identification purposes only, and we are in no way implying that our products are original equipment parts. Prices subject to change without notice.