

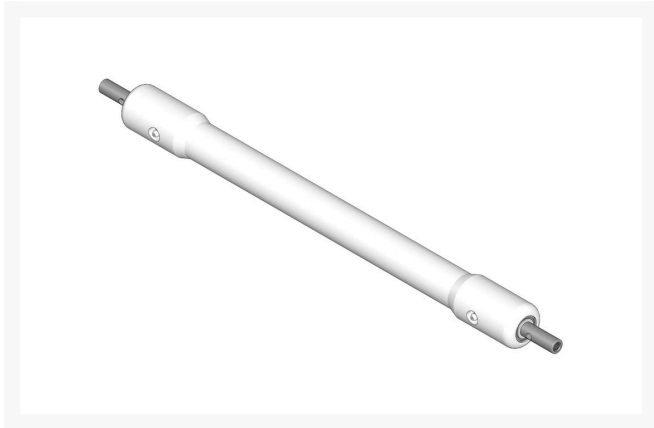

Roller - Swaged Machined Solid Aluminum

R21-6470



Details

Constructed with "water-pump" style bearings, this roller is machined from solid aluminum and contacts the ground only on the outer 2-7/8" of the roller.

Replaces

R&R Products	R10-5000, R52-3590
Toro	10-5000, 21-6470, 52-3590

Specifications

Manufacturer	R&R Products
Overhaul Kit No.	R107-1588
Roller Body	2 in
Diameter	
Weight (lbs)	4 lb

Fits Models

- R&R Products Greens Max 2200LP
- R&R Products Versa-Green 1860
- R&R Products Versa-Green 1860PS
- Toro Greensmaster 1000
- Toro Greensmaster 1010
- Toro Greensmaster 2000
- Toro Greensmaster 3
- Toro Greensmaster 300
- Toro Greensmaster 3000
- Toro Greensmaster 3050
- Toro Greensmaster 3100
- Toro Greensmaster 3150-Q
- Toro Greensmaster Series 4

R&R Products Inc

3334 E Milber St Tucson, 85714
800-528-3446

<https://www.rrproducts.com/>



Roller - Swaged Machined Solid Aluminum

R21-6470



Replacement Parts

R107-1588

R52-3180

R302-5

Overhaul Kit - Roller

Bearing - Front Roller

Fitting - Grease

R&R Products Inc

3334 E Milber St Tucson, 85714

800-528-3446

<https://www.rrproducts.com/>