

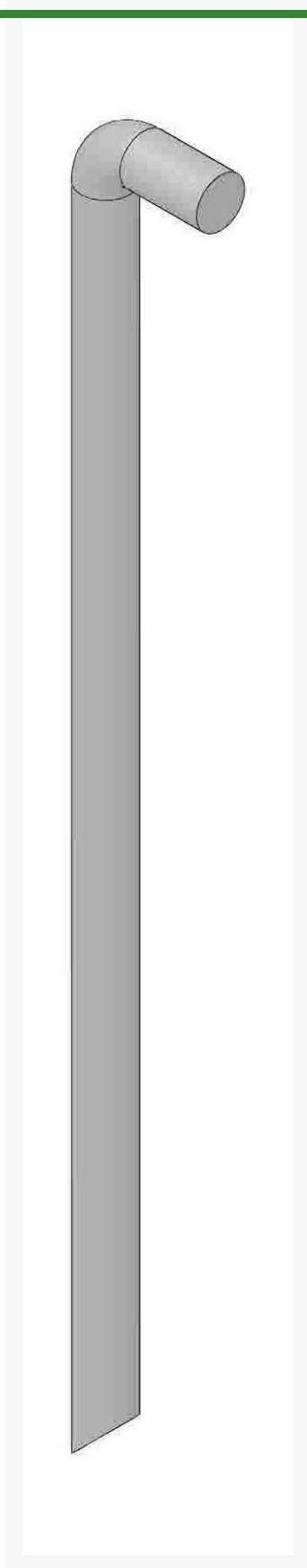

# Alloy Solid Needle Tine - .315MT x 7.380L x .315OD R100-3621



## Details

Alloy Solid Tines aerate without the work of cleaning up the mess of cores and debris left behind with conventional core aerating. R&R Solid Tines are manufactured from a special high-carbon steel bar and heat treated to RC45-48 in our own heat treatment facility. They are available in all standard sizes but are especially popular in the smaller diameters for aerating in the summer months to relieve the stress on greens by allowing water, air and nutrients to easily flow into the root zone. With the combination of small holes and no cores, play can be resumed immediately.

## Replaces

Toro	100-3621
------	----------

## Specifications

Manufacturer	R&R Products
B - Tine Mounting Dia.	.315 in (8mm)
C - Tine Length	7.38 in (187mm)
D - Tine Tip Outside (Hole) Dia.	.315 in (8mm)

## Fits Models

- Toro ProCore 1298
- Toro ProCore 440
- Toro ProCore 648
- Toro ProCore 660
- Toro ProCore 864
- Toro ProCore 880
- Toro ProCore 648s

## R&R Products Inc

3334 E Milber St Tucson, 85714  
800-528-3446

<https://www.rrproducts.com/>