

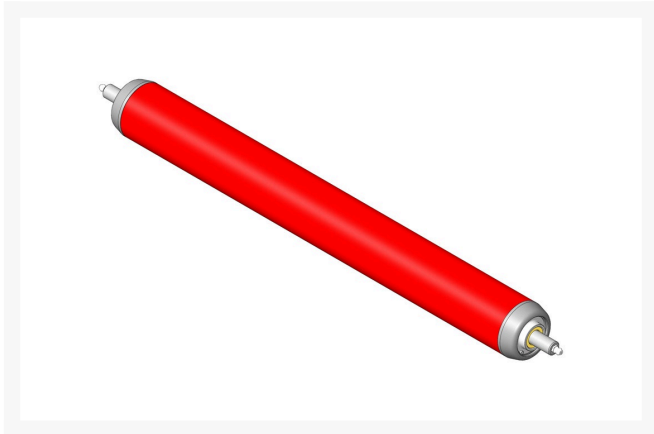

Roller - Smooth Tubular Steel

R107-4040



Details

Constructed with a through shaft, this heavy-duty roller uses greasable ball bearings. (2006 - 2007)

Replaces

R&R Products	107-4040
Toro	107-4040

Specifications

Manufacturer	R&R Products
Overhaul Kit No.	R106-9606
Roller Body	2.5 in
Diameter	
Weight (lbs)	13.5 lb

Fits Models

- R&R Products Reel Max 544D
- Toro Reelmaster 5210-D
- Toro Reelmaster 5410-D
- Toro Reelmaster 5410G
- Toro Reelmaster 5510-D
- Toro Reelmaster 5510-G
- Toro Reelmaster 5610-D
- Toro Reelmaster 6500D
- Toro Reelmaster 6700D

Replacement Parts

R106-9606	Overhaul Kit - Roller
R107-3296	Shaft - Rear Long Roller
R93-3007	Seal
R343667	Bearing - Ball
R93-1251	Seal
R93-1252	Seal - Outer

R&R Products Inc

3334 E Milber St Tucson, 85714
800-528-3446

<https://www.rrproducts.com/>



Roller - Smooth Tubular Steel

R107-4040



R253-70

Seal

R93-2931

Washer - Roller Seal

R32120-62

Ring - Retaining

R302-5

Fitting - Grease

R&R Products Inc

3334 E Milber St Tucson, 85714

800-528-3446

<https://www.rrproducts.com/>