

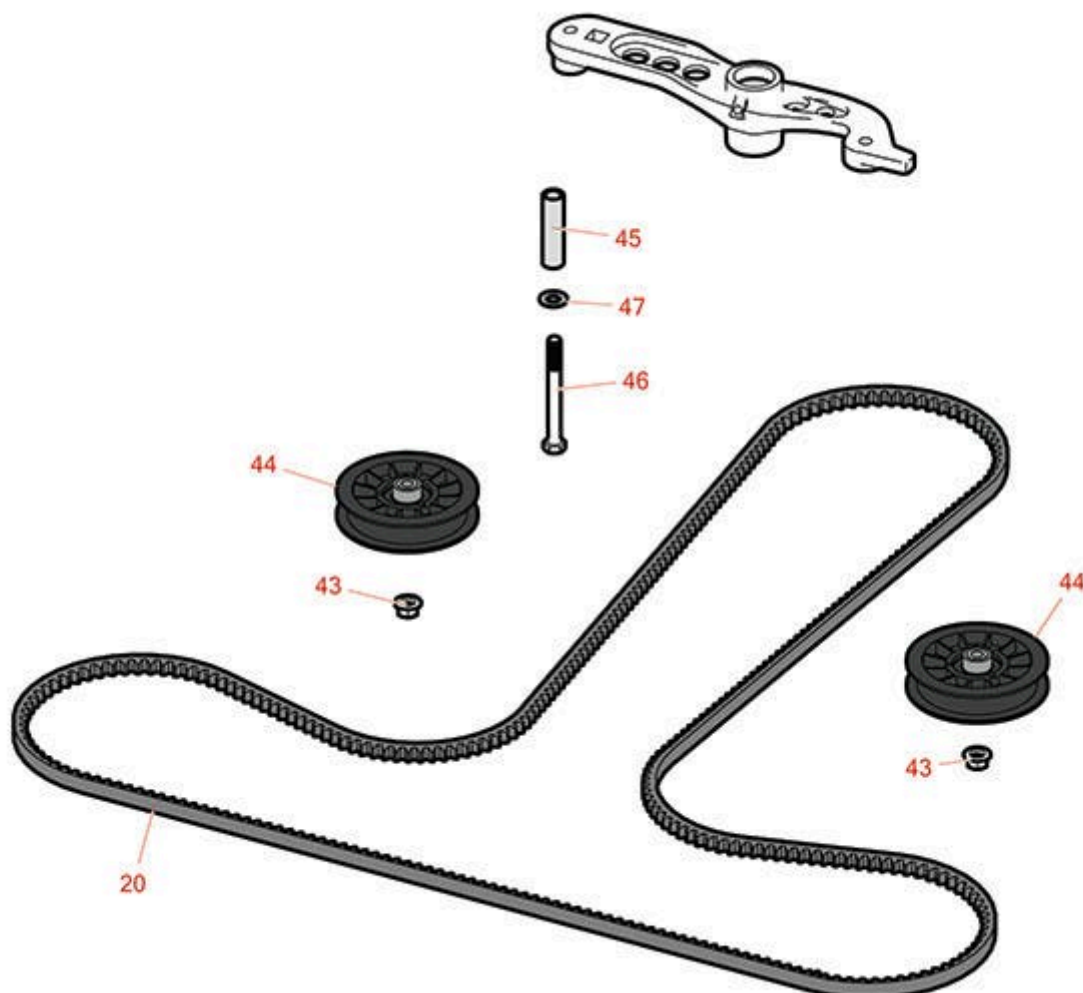

## Replaces Exmark Radius E-Series Parts

44in Rotary Mower - Model RAE702GEM44300,  
RAE708GEM44300  
Engine



All original equipment manufacturers names and part numbers are used for identification purposes only, and we are in no way implying that our products are original equipment parts. Prices subject to change without notice.



## Replaces Exmark Radius E-Series Parts

44in Rotary Mower - Model RAE702GEM44300,  
RAE708GEM44300  
Engine



| Item No      | R&R Part No.     | OEM Part No.  | Description                      | Qty Req | Price Each   | Order Quantity |
|--------------|------------------|---|----------------------------------|---------|--------------|----------------|
| <b>Belts</b> |                  |   |                                  |         |              |                |
| 20           | <b>R115-9613</b> | 115-9613  | Belt - Cogged V                  | 1       | <b>34.05</b> |                |
| 43           | <b>R104-8301</b> | 104-8301,<br>109-6658   | Locknut - 3/8-16 Nylon Flanged   | 23      | <b>0.88</b>  |                |
| 44           | <b>R116-2456</b> | 116-2456  | Pulley - Flat Idler w/Bushing    | 2       | <b>17.59</b> |                |
| 45           | <b>R1-603384</b> | 1-603384  | Bushing-Pivot, Idler             | 1       | <b>11.95</b> |                |
| 46           | <b>R323-15</b>   | 323-15  | Bolt - Hex HD 3/8-16 x 3-1/2 GR5 | 1       | <b>1.45</b>  |                |
| 47           | <b>R453011</b>   | 3256-23,<br>3256-24,<br>3256-3,<br>3256-4,<br>48-9220,<br>80-7730 | Washer - Flat 3/8 SAE Y/Zinc     | 1       | <b>0.12</b>  |                |

All original equipment manufacturers names and part numbers are used for identification purposes only, and we are in no way implying that our products are original equipment parts. Prices subject to change without notice.