

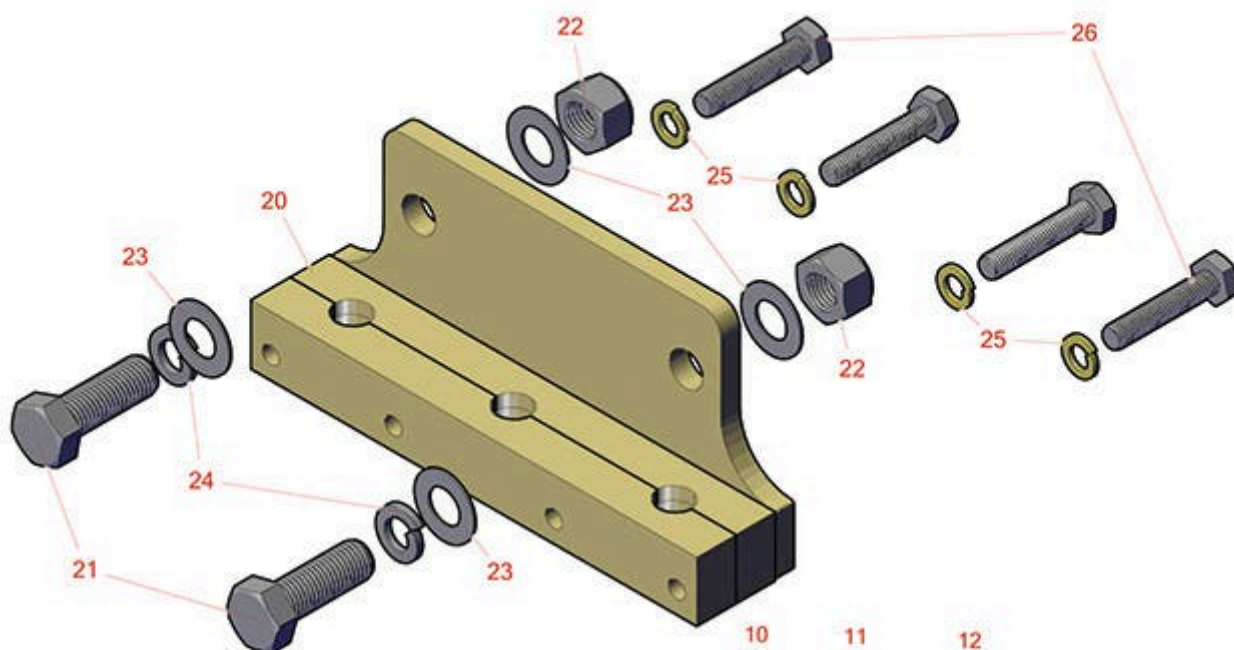

Replaces Toro ProCore 660 Parts

Aerating Unit

3-Tine Head - Model 09722



NOTE: #21, #23 and #24 are used when #22 is not present
or #21 and #23 are used when #22 is present



NOTE: TINES NOT SUPPLIED WITH KIT



Replaces Toro ProCore 660 Parts

Aerating Unit

3-Tine Head - Model 09722



Item No	R&R Part No.	OEM Part No.	Description	Qty Req	Price Each	Order Quantity
---------	--------------	--------------	-------------	---------	------------	----------------

Tines

10	R100-3626	100-3626, 108-9211	Alloy Solid Tine - .750MT x 6.375L x .354OD	3	8.60	
----	------------------	-----------------------	--	---	-------------	--

***Detail Description:** Alloy Solid Tines aerate without the work of cleaning up the mess of cores and debris left behind with conventional core aerating. R&R Solid Tines are manufactured from a special high-carbon steel bar and heat treated to RC45-48 in our own heat treatment facility. They are available in all standard sizes but are especially popular in the smaller diameters for aerating in the summer months to relieve the stress on greens by allowing water, air and nutrients to easily flow into the root zone. With the combination of small holes and no cores, play can be resumed immediately.:*

10	R100-3627	100-3627, 108-9212	Alloy Solid Tine - .750MT x 6.375L x .394OD	3	8.60	
----	------------------	-----------------------	--	---	-------------	--

***Detail Description:** Alloy Solid Tines aerate without the work of cleaning up the mess of cores and debris left behind with conventional core aerating. R&R Solid Tines are manufactured from a special high-carbon steel bar and heat treated to RC45-48 in our own heat treatment facility. They are available in all standard sizes but are especially popular in the smaller diameters for aerating in the summer months to relieve the stress on greens by allowing water, air and nutrients to easily flow into the root zone. With the combination of small holes and no cores, play can be resumed immediately.:*

10	R100-3628	100-3628	Alloy Solid Tine - .750MT x 6.375L x .433OD	3	8.60	
----	------------------	----------	--	---	-------------	--

***Detail Description:** Alloy Solid Tines aerate without the work of cleaning up the mess of cores and debris left behind with conventional core aerating. R&R Solid Tines are manufactured from a special high-carbon steel bar and heat treated to RC45-48 in our own heat treatment facility. They are available in all standard sizes but are especially popular in the smaller diameters for aerating in the summer months to relieve the stress on greens by allowing water, air and nutrients to easily flow into the root zone. With the combination of small holes and no cores, play can be resumed immediately.:*

10	R100-3629	100-3629	Alloy Solid Tine - .750MT x 6.375L x .511OD	3	8.60	
----	------------------	----------	--	---	-------------	--

***Detail Description:** Alloy Solid Tines aerate without the work of cleaning up the mess of cores and debris left behind with conventional core aerating. R&R Solid Tines are manufactured from a special high-carbon steel bar and heat treated to RC45-48 in our own heat treatment facility. They are available in all standard sizes but are especially popular in the smaller diameters for aerating in the summer months to relieve the stress on greens by allowing water, air and nutrients to easily flow into the root zone. With the combination of small holes and no cores, play can be resumed immediately.:*

10	R100-3630	100-3630	Alloy Solid Tine - .750MT x 6.375L x .630OD	3	8.60	
----	------------------	----------	--	---	-------------	--

All original equipment manufacturers names and part numbers are used for identification purposes only, and we are in no way implying that our products are original equipment parts. Prices subject to change without notice.



Replaces Toro ProCore 660 Parts

Aerating Unit

3-Tine Head - Model 09722



Item No	R&R Part No.	OEM Part No.	Description	Qty Req	Price Each	Order Quantity
---------	--------------	--------------	-------------	---------	------------	----------------

Detail Description: Alloy Solid Tines aerate without the work of cleaning up the mess of cores and debris left behind with conventional core aerating. R&R Solid Tines are manufactured from a special high-carbon steel bar and heat treated to RC45-48 in our own heat treatment facility. They are available in all standard sizes but are especially popular in the smaller diameters for aerating in the summer months to relieve the stress on greens by allowing water, air and nutrients to easily flow into the root zone. With the combination of small holes and no cores, play can be resumed immediately.:

11	R108-9133	108-9133	Alloy Hollow Tine - .750MT x 5.750L x .570OD	3	7.20	
----	------------------	----------	---	---	-------------	--

Detail Description: Like Standard Hollow Tines, this tine is also tubular and designed to remove a soil core, but they are constructed from a special high carbon alloy steel. The steel tubing is specially manufactured for R&R to achieve uniform hardness of RC45-48 throughout the tine for excellent wear and toughness. These tines are much tougher and resist bending in extremely hard or rocky soils and you can expect 3-4 times longer life than from the Standard Hollow Tines.:

11	R108-9128	108-9128	Alloy Hollow Tine - .750MT x 4.750L x .470OD	3	7.10	
----	------------------	----------	---	---	-------------	--

Detail Description: Like Standard Hollow Tines, this tine is also tubular and designed to remove a soil core, but they are constructed from a special high carbon alloy steel. The steel tubing is specially manufactured for R&R to achieve uniform hardness of RC45-48 throughout the tine for excellent wear and toughness. These tines are much tougher and resist bending in extremely hard or rocky soils and you can expect 3-4 times longer life than from the Standard Hollow Tines.:

11	R104-0984	100-3635, 104-0984	Standard Hollow Tine - .750MT x 5.750L x .660OD	3	4.15	
----	------------------	-----------------------	--	---	-------------	--

Detail Description: Designed to remove a soil core, R&R Standard Hollow Tines are constructed from case hardened tubular steel and are the most economical tines available. Case hardening hardens the inner and outer surfaces of the tine wall to over RC55 for added wear.:

11	R523472	100-3634	Standard Hollow Tine - .750MT x 5.500L x .520OD	3	4.15	
----	----------------	----------	--	---	-------------	--

Detail Description: Designed to remove a soil core, R&R Standard Hollow Tines are constructed from case hardened tubular steel and are the most economical tines available. Case hardening hardens the inner and outer surfaces of the tine wall to over RC55 for added wear.:

11	R59-3690	100-3633, 59-3690	Standard Hollow Tine - .750MT x 4.750L x .475OD	3	3.85	
----	-----------------	----------------------	--	---	-------------	--

All original equipment manufacturers names and part numbers are used for identification purposes only, and we are in no way implying that our products are original equipment parts. Prices subject to change without notice.



Replaces Toro ProCore 660 Parts

Aerating Unit

3-Tine Head - Model 09722



Item No	R&R Part No.	OEM Part No.	Description	Qty Req	Price Each	Order Quantity
---------	--------------	--------------	-------------	---------	------------	----------------

Detail Description: Designed to remove a soil core, R&R Standard Hollow Tines are constructed from case hardened tubular steel and are the most economical tines available. Case hardening hardens the inner and outer surfaces of the tine wall to over RC55 for added wear.:

12	R104-9875	100-3631, 104-9875, 108-9260, 108-9261	Alloy Side-Eject Spoon - .750MT x 5.75L x .750OD	3	5.95	
----	------------------	---	---	---	-------------	--

Detail Description: Manufactured in our own facility from heavy duty alloy steel and heat treated to RC45-48 for durability and wear, these spoons are formed with an open slot in the side for easy core ejection and to avoid plugging.:

12	R104-9876	100-3632, 104-9876	Alloy Side-Eject Spoon - .750MT x 5.75L x .625OD	3	5.95	
----	------------------	-----------------------	---	---	-------------	--

Detail Description: Manufactured in our own facility from heavy duty alloy steel and heat treated to RC45-48 for durability and wear, these spoons are formed with an open slot in the side for easy core ejection and to avoid plugging.:

Other Parts Available

20	R100-3695	100-3695	Tine Holder - 3 Tine 3/4 Mt	1	192.75	
----	------------------	----------	--------------------------------	---	---------------	--

21	R33118-045	33118-045	Bolt - Hex HD M16-2.0 x 45	2	1.85	
----	-------------------	-----------	-------------------------------	---	-------------	--

22	R33028-00	33028-00	Locknut - 16mm x 2.0 ESNA	2	2.30	
----	------------------	----------	------------------------------	---	-------------	--

23	R33096-00	33096-00	Washer-Flat	2	1.85	
----	------------------	----------	-------------	---	-------------	--

23	R33098-00	33098-00	Flatwasher - 16mm	2	1.60	
----	------------------	----------	-------------------	---	-------------	--

24	R3253-7	01-166-0030, 01-166-0080, 01-166-0290, 01-166-0810, 23-13-GD, 3253-7, 48-9380	Washer - Lock 1/2	2	0.14	
----	----------------	---	-------------------	---	-------------	--

All original equipment manufacturers names and part numbers are used for identification purposes only, and we are in no way implying that our products are original equipment parts. Prices subject to change without notice.



Replaces Toro ProCore 660 Parts

Aerating Unit

3-Tine Head - Model 09722



Item No	R&R Part No.	OEM Part No.	Description	Qty Req	Price Each	Order Quantity
25	R48-9590	01-176-0040, 42-9600, 48-9590, 48-9690, 63-7780	Washer - Lock 10mm	4	0.43	
26	R33115-050	33115-050	Bolt - Hex HD M10-1.5 x 50	4	1.50	
26	R323-8	01-150-0060, 01-178-0612, 20-49-AD, 20-49-AGD, 323-8, 3273-41, 908036P	Bolt - Hex HD 3/8-16 x 1-1/2 GR8	4	1.60	

All original equipment manufacturers names and part numbers are used for identification purposes only, and we are in no way implying that our products are original equipment parts. Prices subject to change without notice.