

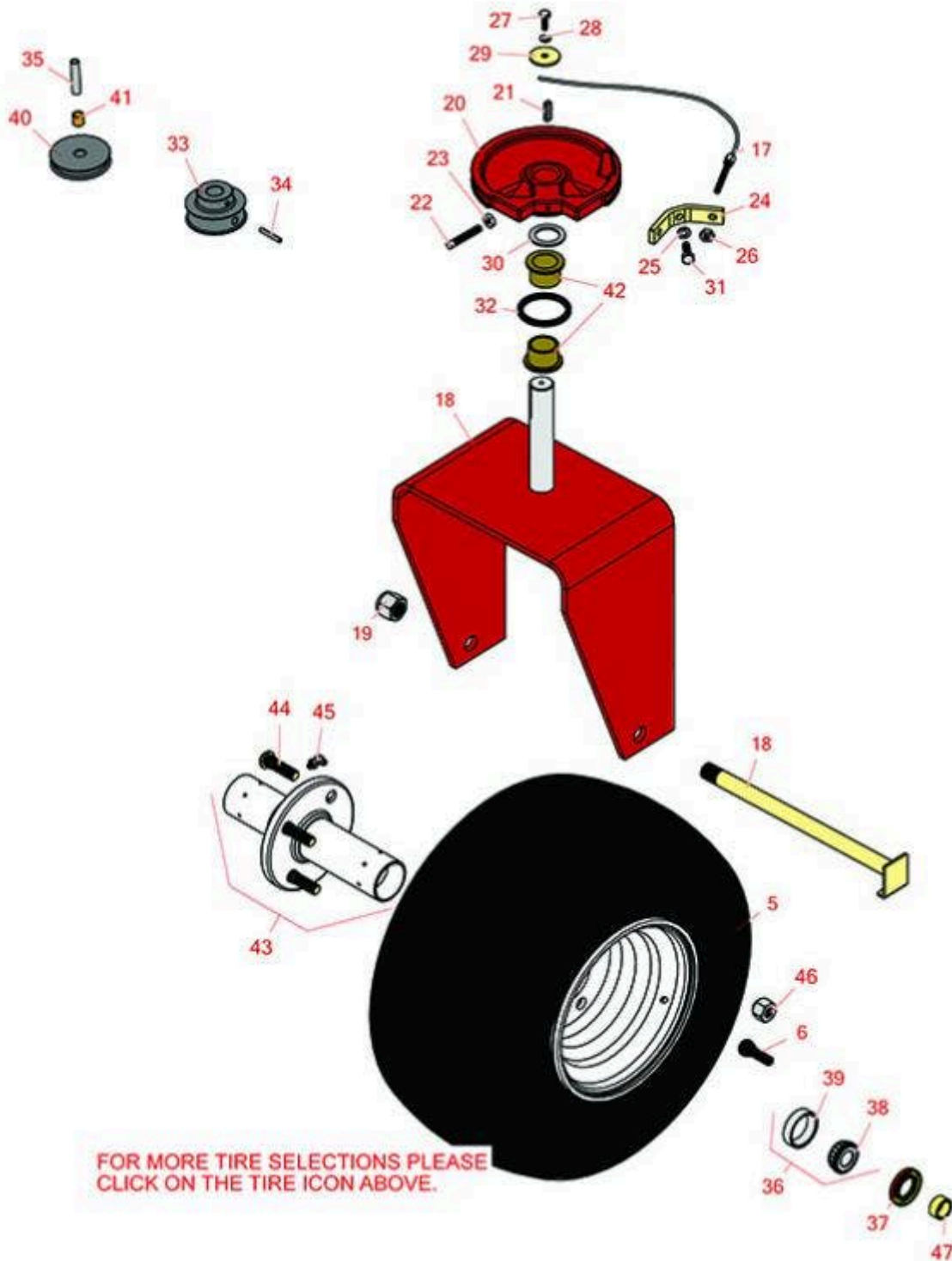

Replaces Toro Greensmaster 300 Parts

*Traction Unit - Model 04345
Rear Wheel & Seat*



FOR MORE TIRE SELECTIONS PLEASE
CLICK ON THE TIRE ICON ABOVE.

All original equipment manufacturers names and part numbers are used for identification purposes only, and we are in no way implying that our products are original equipment parts. Prices subject to change without notice.



Replaces Toro Greensmaster 300 Parts

Traction Unit - Model 04345

Rear Wheel & Seat



Item No	R&R Part No.	OEM Part No.	Description	Qty Req	Price Each	Order Quantity
---------	--------------	--------------	-------------	---------	------------	----------------

Tires

5	RCT510981		Tire - 18 - 9.50 x 8 (4 Ply) Carlisle Smooth	1	79.90	
<i>Tech Note: See Tire Section for Complete Selection:</i>						
5	RTK958-4SM-I	28-3680	Tire - 18x9.50-8 (4 Ply) Kenda Smooth	1	90.90	
5	R150314		Tire w/Wheel - 18x9.50-8 (2 Ply) Carlisle Smooth	1	128.45	
5	R217-60	217-60, 242-49	Wheel - with Valve Stem - White	1	59.05	
5	R700141	232-37, 232-47	Tube - 18x6.50/7.50/8.50/9.50-8 TR13	1	10.30	
6	R232-24	232-24, 232-35	Stem - Valve w/ Cap	1	3.25	

Other Parts Available

17	R49-5960	49-5960	Cable - Steering Fits GM300	1	39.95	
17	R62-2180	62-2180	Cable - Steering Fits GM3000	1	36.20	
18	R49-5830	49-5830	Caster Fork - Fits GM300	1	186.15	
18	R5-3934	5-3934	Bolt - Steering Caster Fork	1	26.35	
18	R62-2220	62-2220, 62-2220-01	Caster Fork - Fits GM3000	1	187.35	
19	R3296-50	32153-10, 3296-46, 3296-50	Locknut - 3/4-16 Full Hgt	1	2.55	
20	R51-2710	5-1894, 51-2710	Drum - Steering 1-1/8 Bore	1	95.55	
20	R61-9390	61-9390	Drum - Steering 1-3/8 Bore	1	95.30	
21	R5-0946	5-0946	Key - 3/16 x 3/16 x 1-1/8	1	0.65	

All original equipment manufacturers names and part numbers are used for identification purposes only, and we are in no way implying that our products are original equipment parts. Prices subject to change without notice.



Replaces Toro Greensmaster 300 Parts

Traction Unit - Model 04345

Rear Wheel & Seat



Item No	R&R Part No.	OEM Part No.	Description	Qty Req	Price Each	Order Quantity
21	R5-0698	21-704-0521, 32-504-0801, 5-0698, 65-004-1841, 66-004-2291, 67-004-1401, 80-004-0341, 82-004-1171, 83-004-0431	Key - 1/4 x 1/4 x 1-1/8	1	1.90	
22	R3242-9	3242-9	Screw - Sq. HD Set 5/16-18	1	1.25	
23	R443106	01-188-0518, 22-12-AJD, 32111-4, 3217-4, 3217-6, 3218-2, 513295, 513412, 915112P, 915978, 915979	Nut - 5/16-18 Y/Zinc Plated	1	0.19	
24	R3-8516	3-8516	Anchor - Steering Drum Cable	1	5.70	
25	R3253-4	01-166-0110, 01-166-0510, 23-10-GD, 24-7170, 30-8520, 3253-4, 42-9850, 48-9350, 48-9360, 48-9570, 68-9420, 99-7577	Washer - Lock 5/16 Zinc	6	0.14	
26	R444754	01-189-0518, 3296-4	Locknut - 5/16-24 Center	2	0.43	

All original equipment manufacturers names and part numbers are used for identification purposes only, and we are in no way implying that our products are original equipment parts. Prices subject to change without notice.



Replaces Toro Greensmaster 300 Parts

Traction Unit - Model 04345

Rear Wheel & Seat



Item No	R&R Part No.	OEM Part No.	Description	Qty Req	Price Each	Order Quantity
27	R321-4	01-150-1030, 01-178-0406, 20-3-AGD, 321-4, 3222-1	Bolt - Hex HD 1/4-20 x 3/4	1	0.52	
27	R400184	322-2, 322-3	Screw - 5/16-18 x 3/4 Hex	1	0.62	
28	R3253-3	01-166-0070, 01-166-0410, 23-9-GD, 24-7150, 3253-3, 3256-1, 352-167	Washer - Lock 1/4	1	0.11	
29	R13-3710	13-3710, 22-7490	Washer - Steering Drum	1	1.45	
29	R62-2190	62-2190	Washer	1	1.25	
30	R3-6558	3-6558	Washer - Thrust	1	1.55	
30	R62-2170	62-2170	Washer - Thrust	1	1.45	
31	R322-5	01-178-0508, 20-26-AD, 20-26-AGD, 30-9000, 322-5, 513341, 519755, 908019P, N/A	Bolt - Hex HD 5/16-18 x 1	1	0.40	
32	R237-148	237-148	Seal - Steering Fork	1	3.75	
33	R10-7210	10-7210	Pulley - Front Steering	1	72.45	
33	R62-2160	62-2160	Pulley - Fits Gm 3000	1	47.40	
34	R32121-34	32121-34	Pin - Roll 3/16 x 1-1/2	1	1.30	
35	R10-7240	10-7240	Spacer - Steering Pulley	1	4.15	

All original equipment manufacturers names and part numbers are used for identification purposes only, and we are in no way implying that our products are original equipment parts. Prices subject to change without notice.



Replaces Toro Greensmaster 300 Parts

Traction Unit - Model 04345

Rear Wheel & Seat



Item No	R&R Part No.	OEM Part No.	Description	Qty Req	Price Each	Order Quantity
36	R500534	1-633585	Bearing - with Cup	2	11.80	
37	R253-111	253-108, 253-111	Seal	2	5.30	
38	R254-78	01-102-0060, 01-102-0130, 1-633585, 254-78, 32-7790, 32-9580, 93-4813	Tapered Bearing Cone	2	6.05	
39	R254-79	01-103-0060, 01-103-0130, 1-633584, 252-106, 254-79, 32-7800, 32-9590	Cup - Bearing	2	3.20	
<i>Tech Note: Use R254-79M installation mandrel to properly install race.:</i>						
40	R5-2653	5-2653	Pulley - Idler Steering Cable	4	22.95	
41	R256-2	256-2	Bushing - Idler Pulley	4	3.25	
42	R256-150	256-150	Bushing - Bronze Castor	2	6.55	
43	R75-9440	217-95, 75-9440	Hub - Rear Wheel - Incl Wheel Studs	1	47.45	
44	R10-6830	10-6830, 75-9440	Stud - Wheel 1/2-20 x 1 3/4	4	8.50	
45	R700414	302-11, 302-19, 302-4, 32-8170	Zerk - Grease 1/4-28 45 Deg	1	0.76	
46	R242-50	242-50	Nut - 1/2-20 Wheel	4	1.50	
47	R74-3730	217-96, 74-3730	Spacer	2	3.15	

All original equipment manufacturers names and part numbers are used for identification purposes only, and we are in no way implying that our products are original equipment parts. Prices subject to change without notice.