

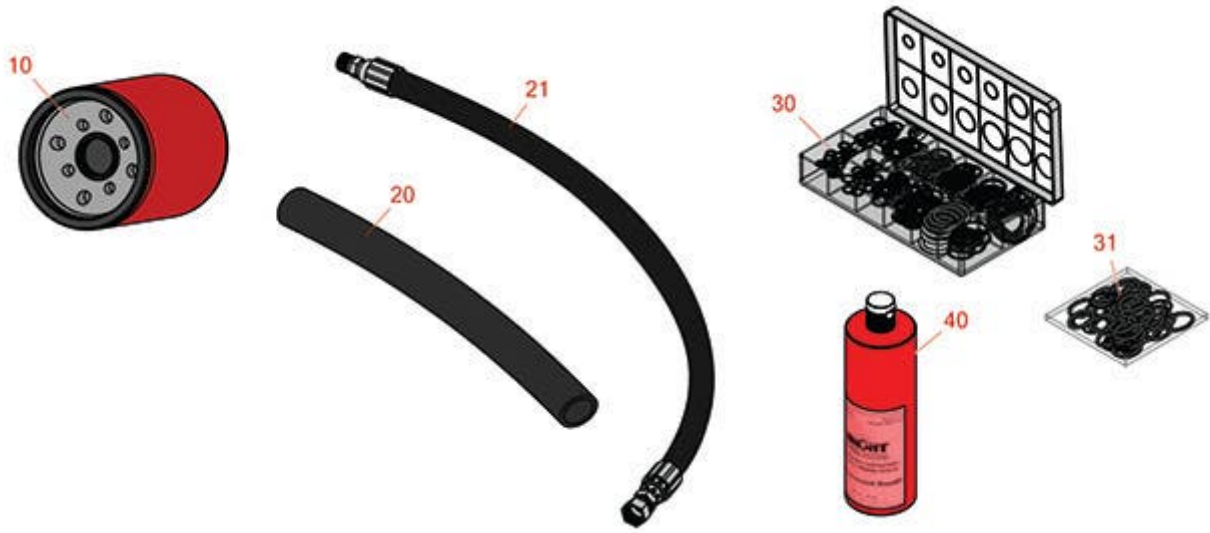

# Replaces Toro Greensmaster 300 Parts

Traction Unit - Model 04345

Hydraulics



All original equipment manufacturers names and part numbers are used for identification purposes only, and we are in no way implying that our products are original equipment parts. Prices subject to change without notice.



# Replaces Toro Greensmaster 300 Parts

Traction Unit - Model 04345

Hydraulics



Item No	R&R Part No.	OEM Part No.	Description	Qty Req	Price Each	Order Quantity
---------	--------------	--------------	-------------	---------	------------	----------------

## Filters

10	<b>R28-2110</b>	28-2110, 445340, 570990	Filter - Hyd Oil 25 Micron	1	<b>27.90</b>	
----	-----------------	-------------------------------	----------------------------	---	--------------	--

## Hoses

20	<b>R27-3040</b>	27-3040	Hydraulic Hose Assy - Tank to Pump	2	<b>24.45</b>	
----	-----------------	---------	------------------------------------	---	--------------	--

21	<b>R63-3810</b>	63-3810, 95-5984	Hydraulic Hose Assy - RH Pressure	1	<b>58.60</b>	
----	-----------------	---------------------	-----------------------------------	---	--------------	--

21	<b>R63-3830</b>	63-3830, 95-5989	Hydraulic Hose Assy - LH Return	1	<b>35.10</b>	
----	-----------------	---------------------	---------------------------------	---	--------------	--

*Tech Note: Hydraulic hose includes protective sleeving.:*

21	<b>R63-3840</b>	63-3840, 95-5987	Hose - Rear Motor Return	1	<b>48.60</b>	
----	-----------------	---------------------	--------------------------	---	--------------	--

*Tech Note: Hydraulic hose includes protective sleeving.:*

21	<b>R63-3850</b>	63-3850	Hose - Cyl LH Drop Fits	1	<b>32.45</b>	
----	-----------------	---------	-------------------------	---	--------------	--

21	<b>R63-3860</b>	63-3860	Hydraulic Hose Assy - Rear Pressure	1	<b>55.20</b>	
----	-----------------	---------	-------------------------------------	---	--------------	--

*Tech Note: Hydraulic hose includes protective sleeving.:*

21	<b>R63-3870</b>	63-3870, 95-5988	Hydraulic Hose Assy - LH Pressure	1	<b>45.25</b>	
----	-----------------	---------------------	-----------------------------------	---	--------------	--

*Tech Note: Hydraulic hose includes protective sleeving.:*

21	<b>R63-3880</b>	63-3880	Hose - RH - Rear Cyl Lift	2	<b>37.60</b>	
----	-----------------	---------	---------------------------	---	--------------	--

21	<b>R63-3890</b>	63-3890	Hose - Cyl LH Lift Fits 3M	1	<b>31.05</b>	
----	-----------------	---------	----------------------------	---	--------------	--

21	<b>R63-3930</b>	63-3930	Hose - Cyl Rear Drop	1	<b>34.25</b>	
----	-----------------	---------	----------------------	---	--------------	--

21	<b>R63-3950</b>	63-3950	Hose - Cyl RH Drop	1	<b>34.65</b>	
----	-----------------	---------	--------------------	---	--------------	--

## Overhaul Kits

All original equipment manufacturers names and part numbers are used for identification purposes only, and we are in no way implying that our products are original equipment parts. Prices subject to change without notice.



# Replaces Toro Greensmaster 300 Parts

Traction Unit - Model 04345

Hydraulics



Item No	R&R Part No.	OEM Part No.	Description	Qty Req	Price Each	Order Quantity
30	<b>R150555</b>		O-Ring Kit - 220 Piece	1	<b>88.45</b>	

*Tech Note: Includes 220 O-Rings:*

31	<b>R353-528</b>	353-528	Seal Kit - Valvebank O-Ring	1	<b>28.70</b>	
----	-----------------	---------	-----------------------------	---	--------------	--

*Tech Note: Includes 24 ea: R21733-001 O-Ring; 16 ea: R21857-001 O-Ring, R340-65 O-Ring, R6814-002 O-Ring:*

### Other Parts Available

40	<b>R525-16</b>		Hydraulic Oil Dye - 16 oz	1	<b>124.40</b>	
----	----------------	--	---------------------------	---	---------------	--

All original equipment manufacturers names and part numbers are used for identification purposes only, and we are in no way implying that our products are original equipment parts. Prices subject to change without notice.