

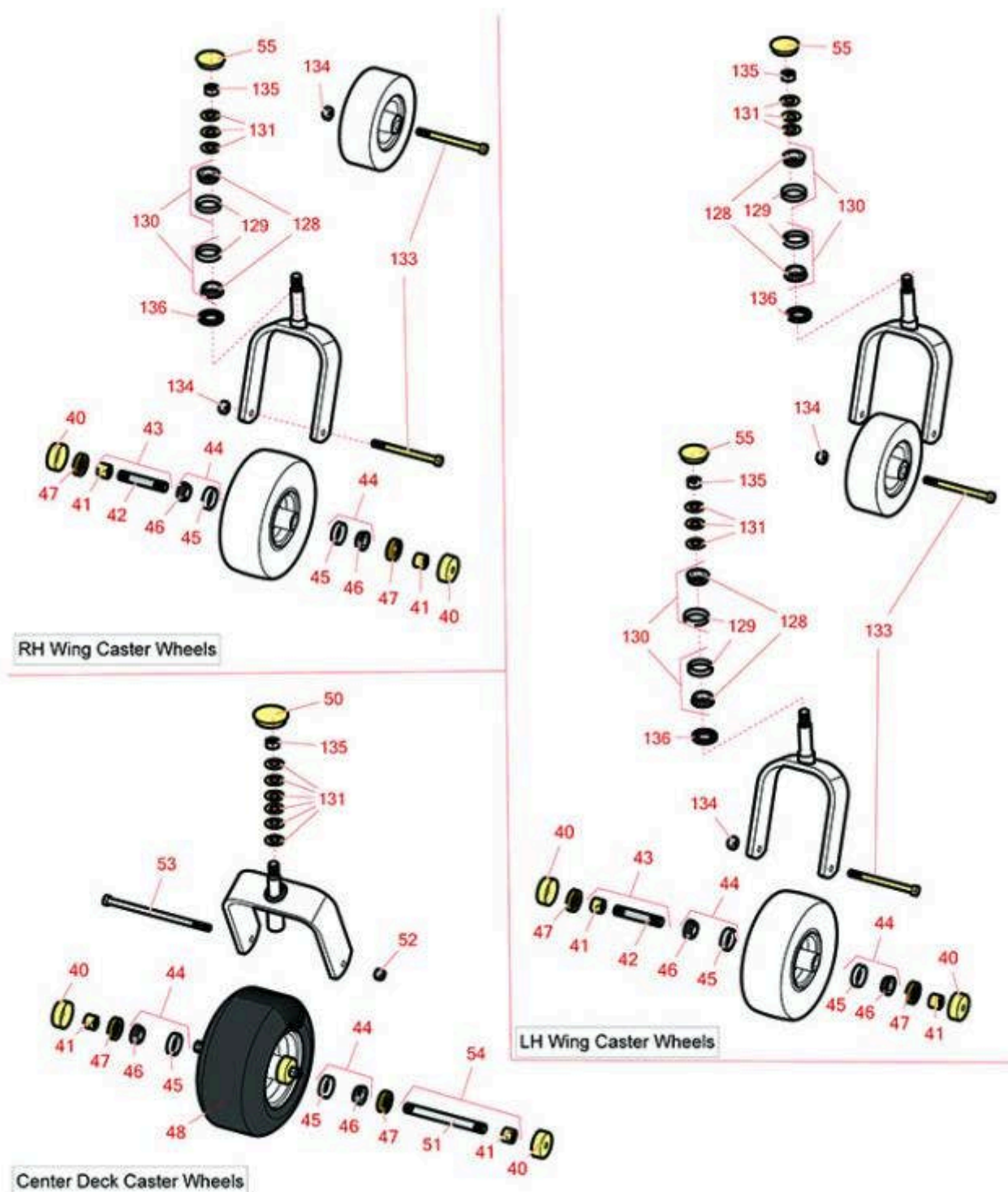

Replaces Exmark Lazer Z X-Series Parts

Zero Turn Mower with 96in Deck - Models LZX980EKC96RW0
Caster Wheel



All original equipment manufacturers names and part numbers are used for identification purposes only, and we are in no way implying that our products are original equipment parts. Prices subject to change without notice.



Replaces Exmark Lazer Z X-Series Parts

Zero Turn Mower with 96in Deck - Models LZX980EKC96RW0
Caster Wheel



Item No	R&R Part No.	OEM Part No.	Description	Qty Req	Price Each	Order Quantity
Other Parts Available						
40	R103-2768	103-2768	Guard - Seal	8	3.45	
41	R103-3051	103-3051	Spacer - Nut - Hardened	8	7.45	
42	R103-3157	103-3157	Axle - Caster Wheel	2	12.05	
43	R126-5359	126-5359	Caster Axle Assy w/Bushing	2	11.85	
44	R500534	1-633585, R & R ONLY	Bearing - with Cup	8	12.40	
<i>Detail Description: Kit includes: 1 ea R254-78- Bearing Cone & R254-79 Bearing Cone:</i>						
45	R254-79	1-633584, R & R ONLY	Cup - Bearing	8	3.40	
<i>Detail Description: Use R254-79M installation mandrel to properly install race.:</i>						
46	R254-78	1-633585	Tapered Bearing Cone	8	6.40	
47	R103-0063	103-0063	Seal - Grease	8	5.15	
48	R109-9127	109-9127	Tire & Wheel - 13x6.50-6 Flat Free	2	127.60	
50	R126-9369	126-9369	Grease Cap - Castor	2	2.30	
51	R103-5156	103-5156	Axle- Caster	2	9.65	
52	RF5003	3296-23	Locknut - ESNA 1/2-13	2	0.82	
53	R325-39	325-39	Bolt - Hx HD 1/2-13 x 9 1/2	2	5.65	
54	R126-5361	126-5361	Axle Assy - with Bushing - Caster	2	12.50	
55	R103-4882	103-4882	Grease Cap - Castor	3	4.45	
128	R254-94	1-543509	Tapered Bearing Cone	6	7.55	
129	R254-72	1-543508	Cup - Bearing	6	4.05	

All original equipment manufacturers names and part numbers are used for identification purposes only, and we are in no way implying that our products are original equipment parts. Prices subject to change without notice.



Replaces Exmark Lazer Z X-Series Parts

Zero Turn Mower with 96in Deck - Models LZX980EKC96RW0
Caster Wheel



Item No	R&R Part No.	OEM Part No.	Description	Qty Req	Price Each	Order Quantity
130	R500596	R & R ONLY	Tapered Bearing Set - Cup and Cone	6	14.65	
131	R1-633508	1-633508	Washer - Spring Disc	21	3.10	
133	R325-20	325-20	Bolt - Hx HD 1/2-13 x 6	4	12.05	
134	R3296-25	3296-45	Locknut - 1/2-13 Heavy ESNA	4	2.30	
135	R3296-51	3296-51	Nut - Nylon Lock 3/4-10 Gr 8	5	5.70	
136	R1-543511	1-543511, R & R ONLY	Seal- Grease	3	7.90	

All original equipment manufacturers names and part numbers are used for identification purposes only, and we are in no way implying that our products are original equipment parts. Prices subject to change without notice.